

Outwards-opening wood aluminium window DW132A

Frame: 132,5x56mm
 Sash thickness: 102,5mm
 Wood: Finger jointed pine; oak; meranti, accoya
 Finishing: RAL catalogue; Teknos stains
 Glazing unit thickness: 50mm
 Fitting system: AURA
 Openings:

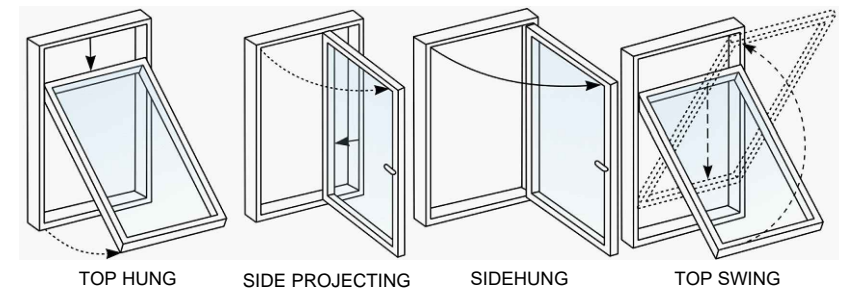

| | | | |
|--|----------------|--------------------------------|-------------|
| OBJEKT: | | | |
| Outward-opening wood aluminium window DW132A - AURA fitting system | | | |
| FAIL: U:\Konstrueerimine\Konstrueerimise projektid 2021\TAANI AKEN\Välja avanev Taani aken | | | |
| KOOSTAS: | Veljo Laanemäe | 29.09.2023 | |
| MUUTIS: | | EN ISO 9001:2000 dok nr: | KEP-11 V01 |
| KOOSKÖLASTAS: | | STAADIUM: | tööprojekt |
| MASTAAP: | Joonis: 1:1,5 | Puit-alumiinium aken Mila AURA | Formaat: A3 |

REKMAN
 HINGEGA TEHTUD AKNAD JA UKSED
 Rekman OÜ
 Reg.Nr.10093586
 EH10093586-0001 ; EP10093586-0001
 Paneeli 4 ,11415 Tallinn
 TEL: 372 601 45 51
 FAX: 372 601 45 59
 E-mail: rekman@rekman.com
 www.rekman.ee

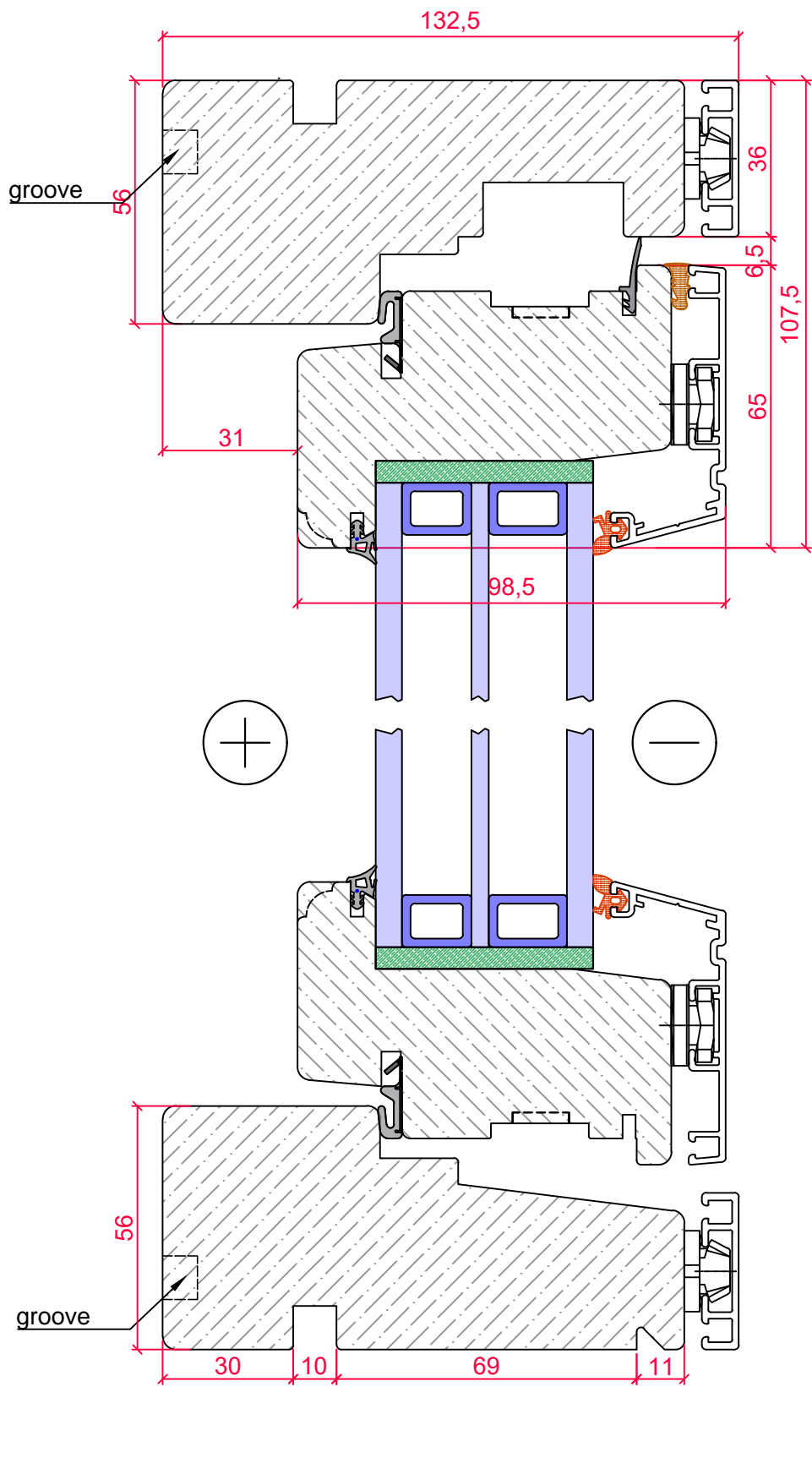

Openable window lower and upper cut - AURA

| | | | |
|---|----------------|------------------------------|---|
| FAIL U:\Konstrueerimine\Konstrueerimise projektid 2021\TAANI AKEN | | | |
| DFRAFT: | VELJO LAANEMÄE | DATE: | 29.09.2023 |
| KOOSKÖLASTAS: | | PROFILE No: | |
| APPROVED: | | | |
| SCALE: 1:1 | | DRAWING NR / SHEET Pos11A | FORMAT: ISO expand A4 (210,00 x 297,00 MM) |



Rekman OÜ
 Reg. Nr. 10093586
 Paneeli 4, 11415 Tallinn
 TEL: 372 601 45 51
 FAX: 372 601 45 59
 E-mail: rekman@rekman.com
 www.rekman.ee

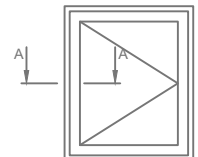
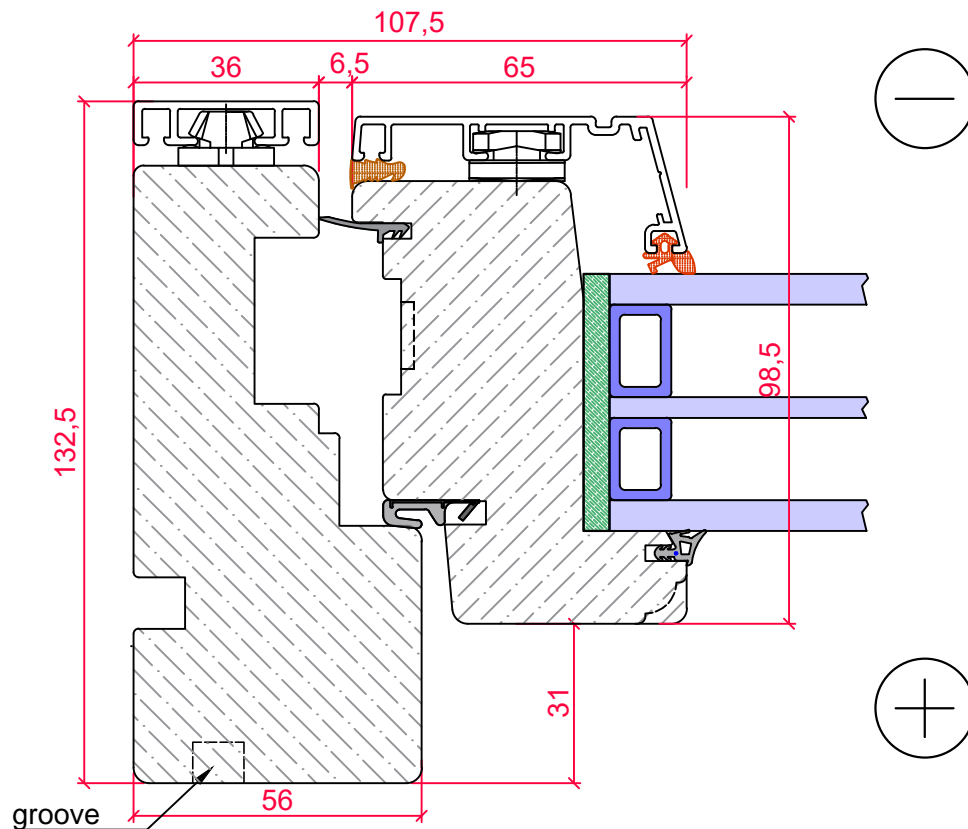

Openable window side cut - AURA

FAIL U:\Konstrueerimine\Konstrueerimise projektid 2021\TAANI AKEN

| | | | |
|---------------|----------------|------------------------------|---|
| DFRAFT: | VELJO LAANEMÄE | DATE: | 29.09.2023 |
| KOOSKÖLASTAS: | | PROFILE No: | |
| APPROVED: | | | |
| SCALE: 1:1 | | DRAWING NR / SHEET Pos22A | FORMAT: ISO expand A4 (210.00 x 297.00 MM) |

REKMAN

Rekman OÜ
 Reg. Nr. 10093586
 Paneeli 4, 11415 Tallinn
 TEL: 372 601 45 51
 FAX: 372 601 45 59
 E-mail: rekman@rekman.com
 www.rekman.ee

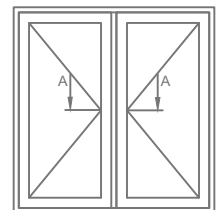
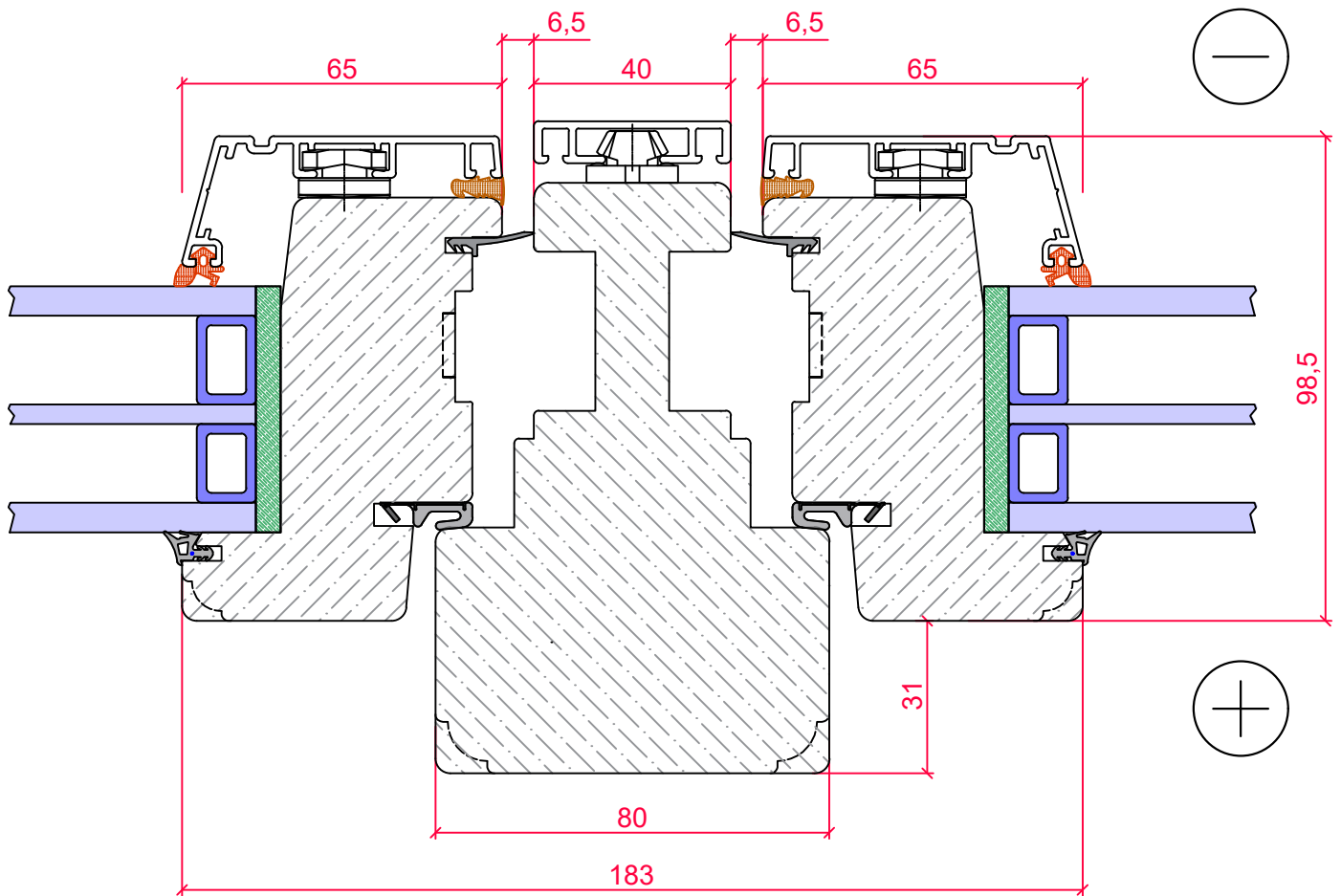

Openable-openable window
vertical post cut - AURA

FAIL U:\Konstrueerimine\Konstrueerimise projektid 2021\TAANI AKEN

| | | | |
|---------------|----------------|------------------------------|---|
| DFRAFT: | VELJO LAANEMÄE | DATE: | 29.09.2023 |
| KOOSKÖLASTAS: | | PROFILE No: | |
| APPROVED: | | | |
| SCALE: 1:1 | | DRAWING NR / SHEET Pos33A | FORMAT: ISO expand A4 (210.00 x 297.00 MM) |

REKMAN
KINGOGA TÄHTSUD AJUMAD JA VEENUD

Rekman OÜ
Reg. Nr. 10093586
Paneeli 4, 11415 Tallinn
TEL: 372 601 45 51
FAX: 372 601 45 59
E-mail: rekman@rekman.com
www.rekman.ee

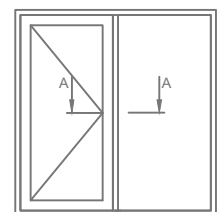
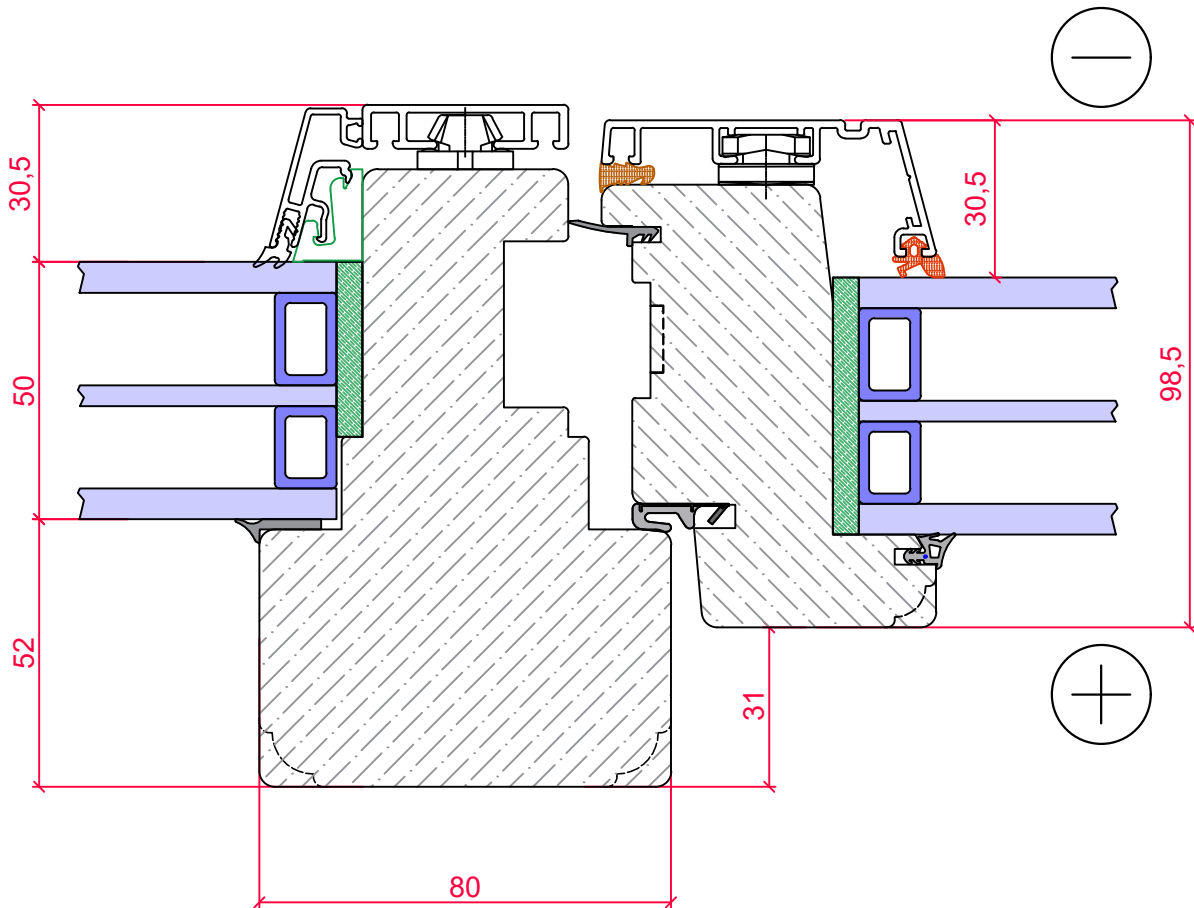

Openable and fixed window vertical post cut - AURA

FAIL U:\Konstrueerimine\Konstrueerimise projektid 2021\TAANI AKEN

| | | | |
|---------------|----------------|------------------------------|---|
| DFRAFT: | VELJO LAANEMÄE | DATE: | 29.09.2023 |
| KOOSKÖLASTAS: | | PROFILE No: | |
| APPROVED: | | | |
| SCALE: 1:1 | | DRAWING NR / SHEET Pos44A | FORMAT: ISO expand A4 (210,00 x 297,00 MM) |

REKMAN

Rekman OÜ
 Reg. Nr. 10093586
 Paneeli 4, 11415 Tallinn
 TEL: 372 601 45 51
 FAX: 372 601 45 59
 E-mail: rekman@rekman.com
 www.rekman.ee

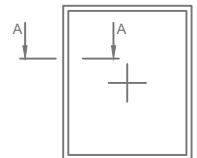
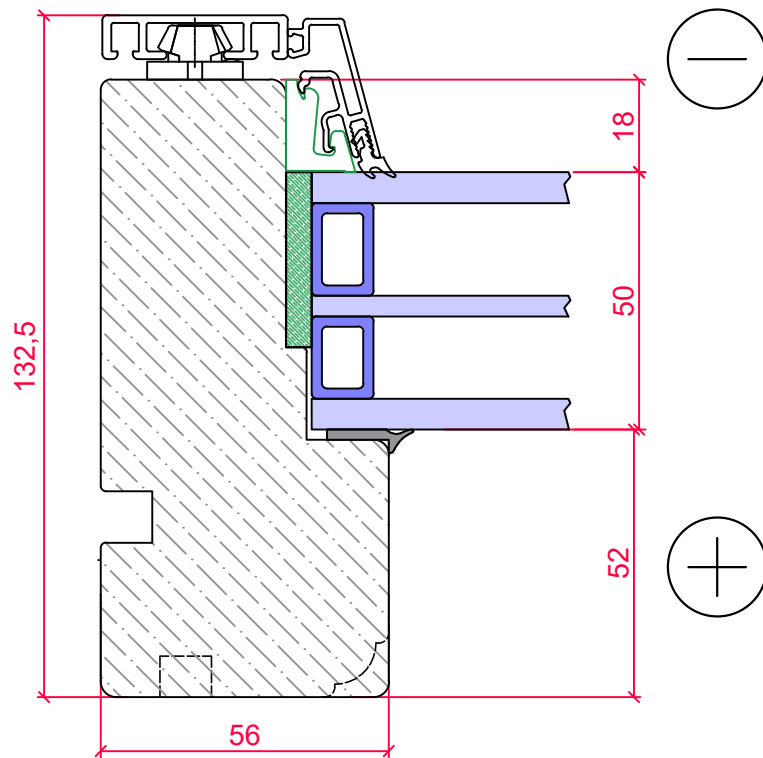

Fixed window side cut - AURA

FAIL U:\Konstrueerimine\Konstrueerimise projektid 2021\TAANI AKEN

| | | | |
|---------------|----------------|------------------------------|---|
| DFRAFT: | VELJO LAANEMÄE | DATE: | 29.09.2023 |
| KOOSKÖLASTAS: | | PROFILE No: | |
| APPROVED: | | | |
| SCALE: 1:1 | | DRAWING NR / SHEET Pos55A | FORMAT: ISO expand A4 (210.00 x 297.00 MM) |

REKMAN

Rekman OÜ
 Reg. Nr. 10093586
 Paneeli 4, 11415 Tallinn
 TEL: 372 601 45 51
 FAX: 372 601 45 59
 E-mail: rekman@rekman.com
 www.rekman.ee

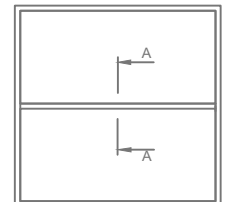
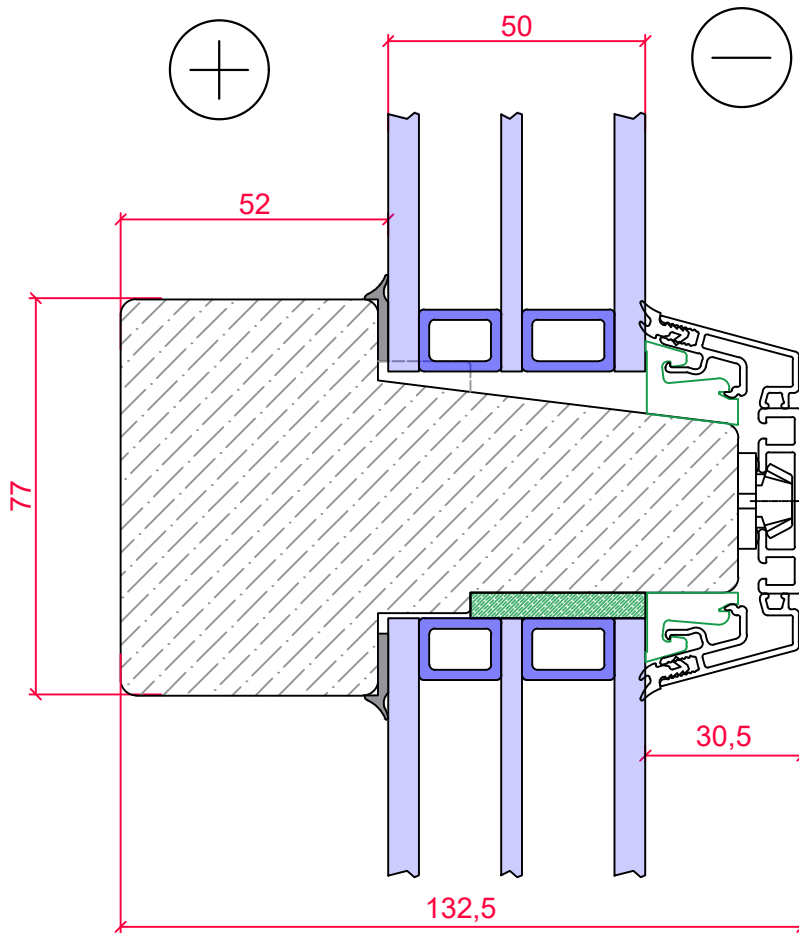

Fixed-fixed window horizontal middle post cut AURA

FAIL U:\Konstrueerimine\Konstrueerimise projektid 2021\TAANI AKEN

| | | | |
|---------------|----------------|------------------------------|---|
| DFRAFT: | VELJO LAANEMÄE | DATE: | 29.09.2023 |
| KOOSKÖLASTAS: | | PROFILE No: | |
| APPROVED: | | | |
| SCALE: 1:1 | | DRAWING NR / SHEET Pos66A | FORMAT: ISO expand A4 (210.00 x 297.00 MM) |

REKMAN

Rekman OÜ
 Reg. Nr. 10093586
 Paneeli 4, 11415 Tallinn
 TEL: 372 601 45 51
 FAX: 372 601 45 59
 E-mail: rekman@rekman.com
 www.rekman.ee

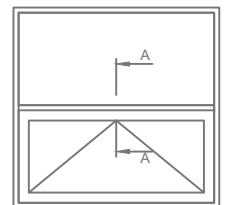
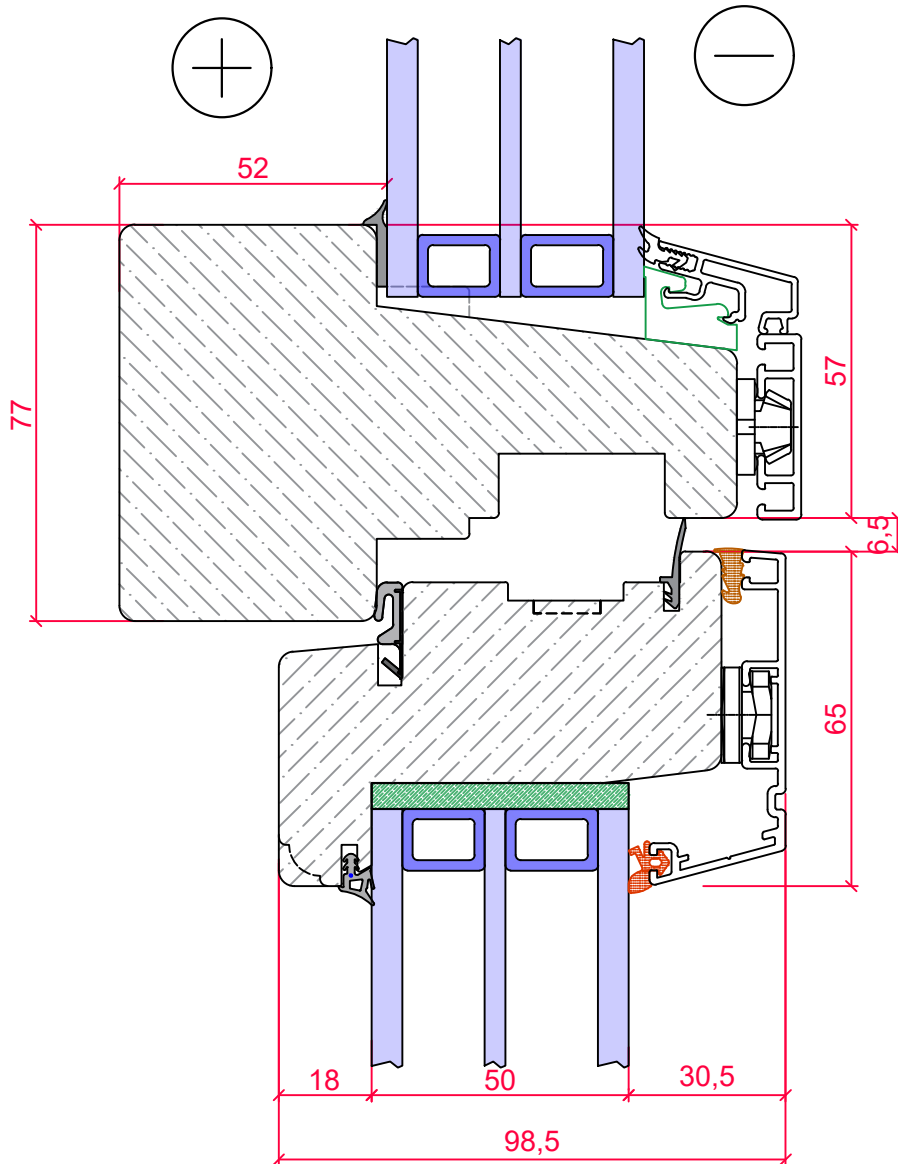

Fixed-openable window horizontal middle
post cut AURA

FAIL U:\Konstrueerimine\Konstrueerimise projektid 2021\TAANI AKEN

| | | | |
|---------------|----------------|------------------------------|---|
| DFRAFT: | VELJO LAANEMÄE | DATE: | 29.09.2023 |
| KOOSKÖLASTAS: | | PROFILE No: | |
| APPROVED: | | | |
| SCALE: 1:1 | | DRAWING NR / SHEET Pos77A | FORMAT: ISO expand A4 (210.00 x 297.00 MM) |

REKMAN

REKMAN OÜ

Reg. Nr. 10093586
 Paneeli 4, 11415 Tallinn

TEL: 372 601 45 51
 FAX: 372 601 45 59
 E-mail: rekman@rekman.com
 www.rekman.ee

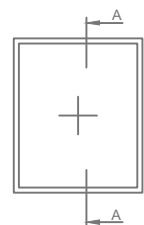
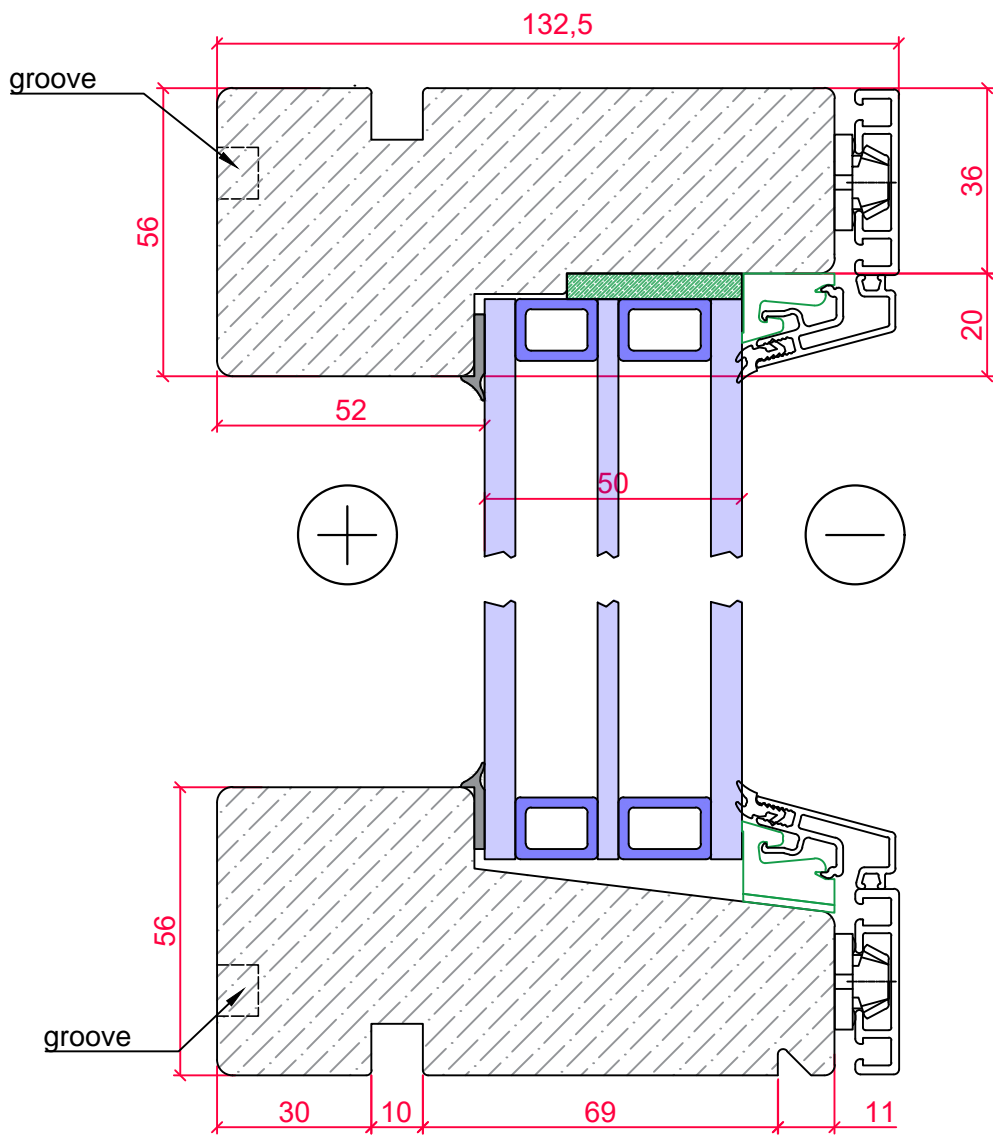

Fixed window lower and upper frame cut - AURA

| | | | |
|---|----------------|------------------------------|---|
| FAIL U:\Konstrueerimine\Konstrueerimise projektid 2021\TAANI AKEN | | | |
| DFRAFT: | VELJO LAANEMÄE | DATE: | 29.09.2023 |
| KOOSKÖLASTAS: | | PROFILE No: | |
| APPROVED: | | | |
| SCALE: 1:1 | | DRAWING NR / SHEET Pos88A | FORMAT: ISO expand A4 (210.00 x 297.00 MM) |



Rekman OÜ
 Reg. Nr. 10093586
 Paneeli 4, 11415 Tallinn
 TEL: 372 601 45 51
 FAX: 372 601 45 59
 E-mail: rekman@rekman.com
 www.rekman.ee

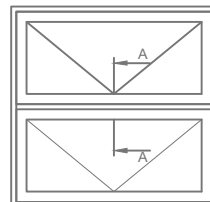
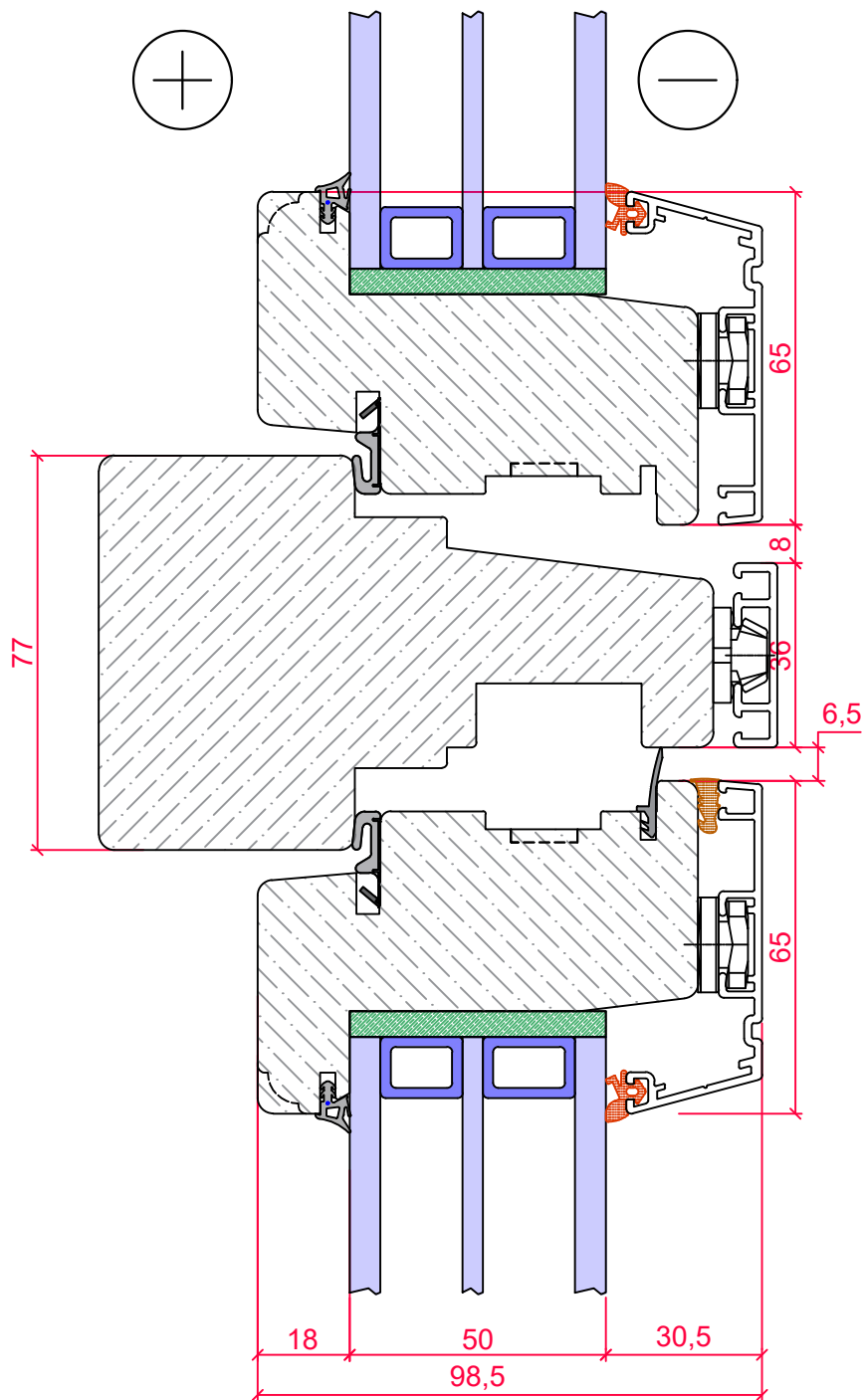

Openable-openable window horizontal middle post cut AURA

FAIL U:\Konstrueerimine\Konstrueerimise projektid 2021\TAANI AKEN

| | | | |
|---------------|----------------|------------------------------|---|
| DFRAFT: | VELJO LAANEMÄE | DATE: | 29.09.2023 |
| KOOSKÖLASTAS: | | PROFILE No: | |
| APPROVED: | | | |
| SCALE: 1:1 | | DRAWING NR / SHEET Pos99A | FORMAT: ISO expand A4 (210.00 x 297.00 MM) |

REKMAN

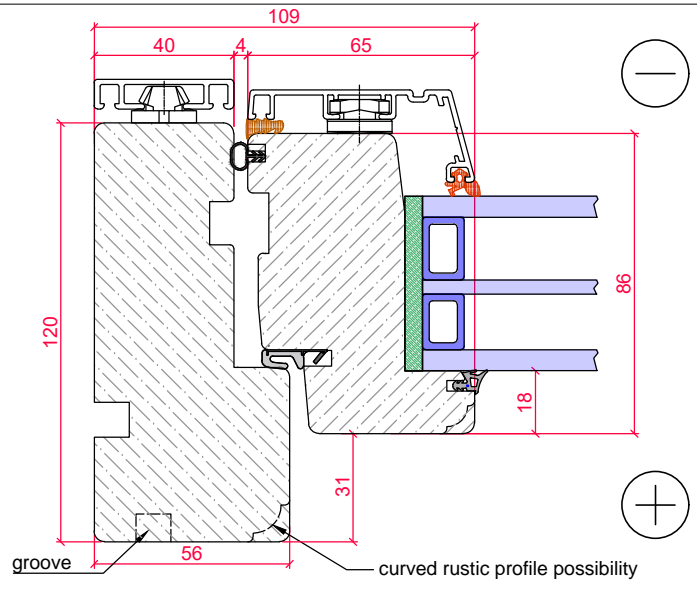
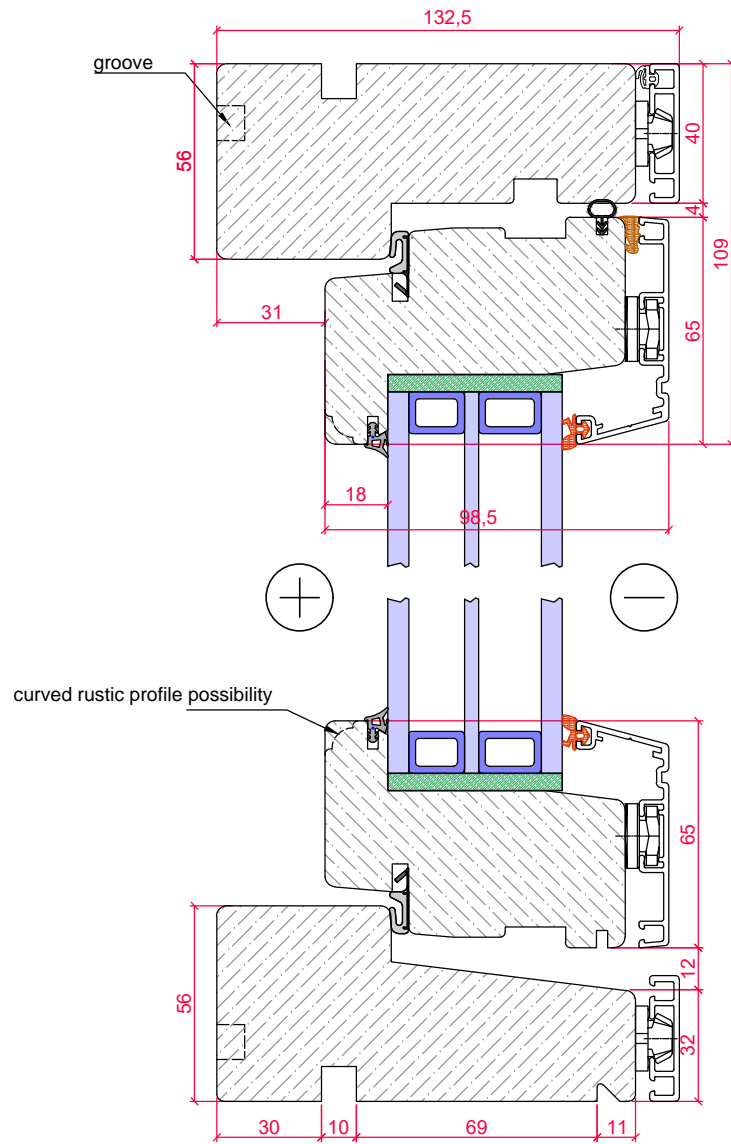

Rekman OÜ
 Reg. Nr. 10093586
 Paneeli 4, 11415 Tallinn
 TEL: 372 601 45 51
 FAX: 372 601 45 59
 E-mail: rekman@rekman.com
 www.rekman.ee



Otwards-opening wood aluminium window DW132A

Frame: 132,5x56mm
 Sash thickness: 102,5mm
 Wood: Finger jointed pine; oak; meranti, accoya
 Finishing: RAL catalogue; Teknos stains
 Glazing unit thickness: 50 mm
 Fitting system: M7

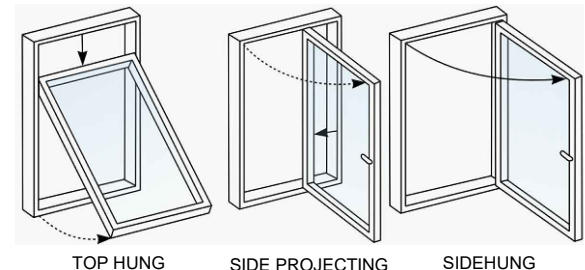
Openings:



| | | | | |
|--|--------------------------|--------------------------|------------|---|
| OBJEKT: Outward-opening wood aluminium DW132A - M7 fitting system | | | |  |
| FAIL: U:\Konstrueerimine\Konstrueerimise projektid 2021\TAANI AKEN\Valja avanev Taani aken | | | | |
| KOOSTAS: | Veljo Laanemäe | | 29.09.2023 | Rekman OÜ Reg.Nr.10093586 EH10093586-0001 ; EP10093586-0001 Paneeli 4, 11415 Tallinn TEL: 372 601 45 51 FAX: 372 601 45 59 E-mail: rekman@rekman.com www.rekman.ee |
| MUUTIS: | | EN ISO 9001:2000 dok nr: | KEP-11 V01 | |
| KOOSKÖLASTAS: | | STAADIUM: | tööprojekt | |
| MASTAAP: | Joonis: | | Formaat: | |
| 1:1,5 | Puit -alumiinium aken M7 | | A3 | |

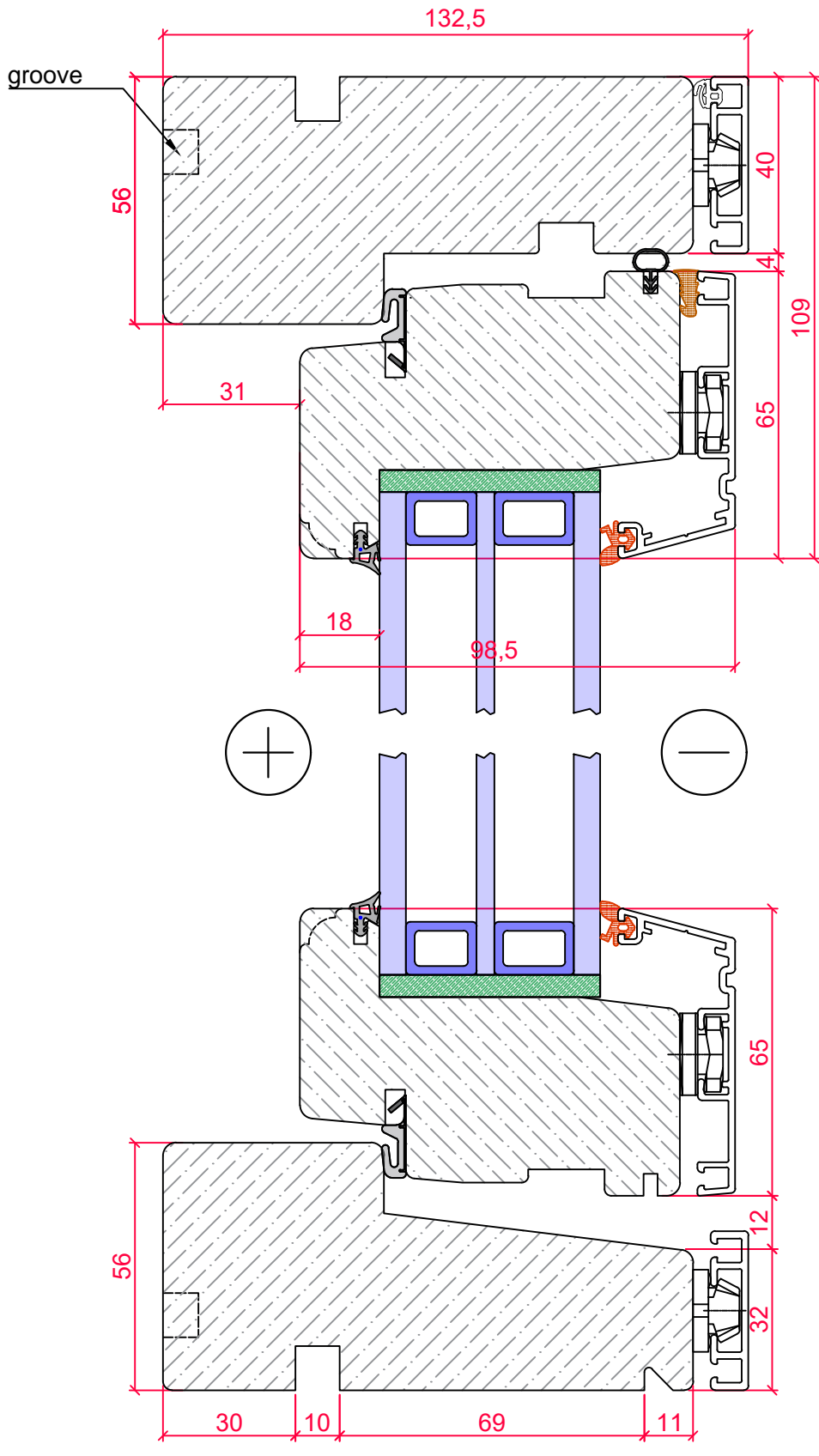

Openable window lower and upper cut - M7

FAIL U:\Konstrueerimine\Konstrueerimise projektid 2021\TAANI AKEN

| | | | |
|---------------|----------------|-----------------------------|---|
| DFRAFT: | VELJO LAANEMÄE | DATE: | 29.09.2023 |
| KOOSKÖLASTAS: | | PROFILE No: | |
| APPROVED: | | | |
| SCALE: 1:1 | | DRAWING NR / SHEET Pos1A | FORMAT: ISO expand A4 (210,00 x 297,00 MM) |

REKMAN

Rekman OÜ
 Reg. Nr. 10093586
 Paneeli 4, 11415 Tallinn
 TEL: 372 601 45 51
 FAX: 372 601 45 59
 E-mail: rekman@rekman.com
 www.rekman.ee

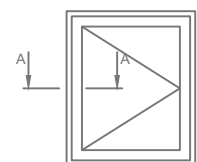
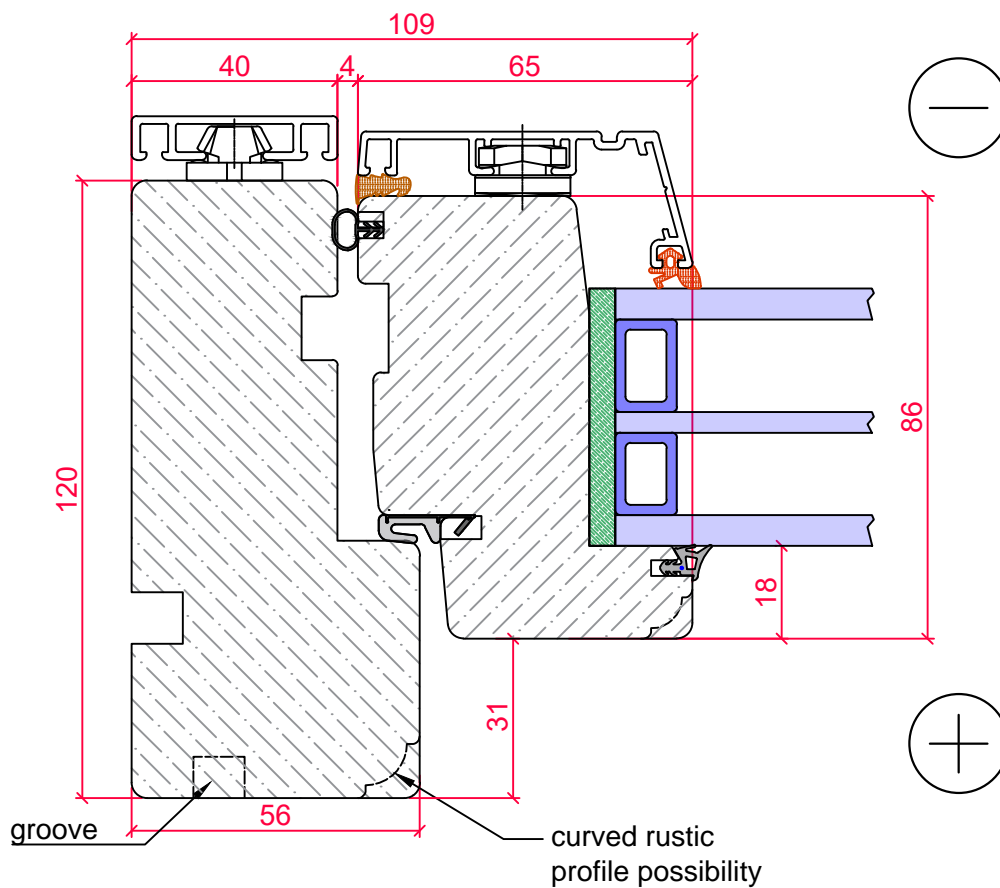

Openable window side cut - M7

FAIL U:\Konstreeerimine\Konstreeerimise projektid 2021\TAANI AKEN

| | | | |
|---------------|----------------|-----------------------------|---|
| DFRAFT: | VELJO LAANEMÄE | DATE: | 29.09.2023 |
| KOOSKÖLASTAS: | | PROFILE No: | |
| APPROVED: | | | |
| SCALE: 1:1 | | DRAWING NR / SHEET Pos2A | FORMAT: ISO expand A4 (210.00 x 297.00 MM) |



Rekman OÜ
 Reg. Nr. 10093586
 Paneeli 4, 11415 Tallinn
 TEL: 372 601 45 51
 FAX: 372 601 45 59
 E-mail: rekman@rekman.com
 www.rekman.ee

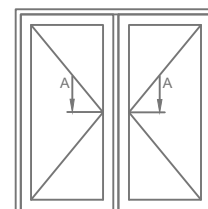
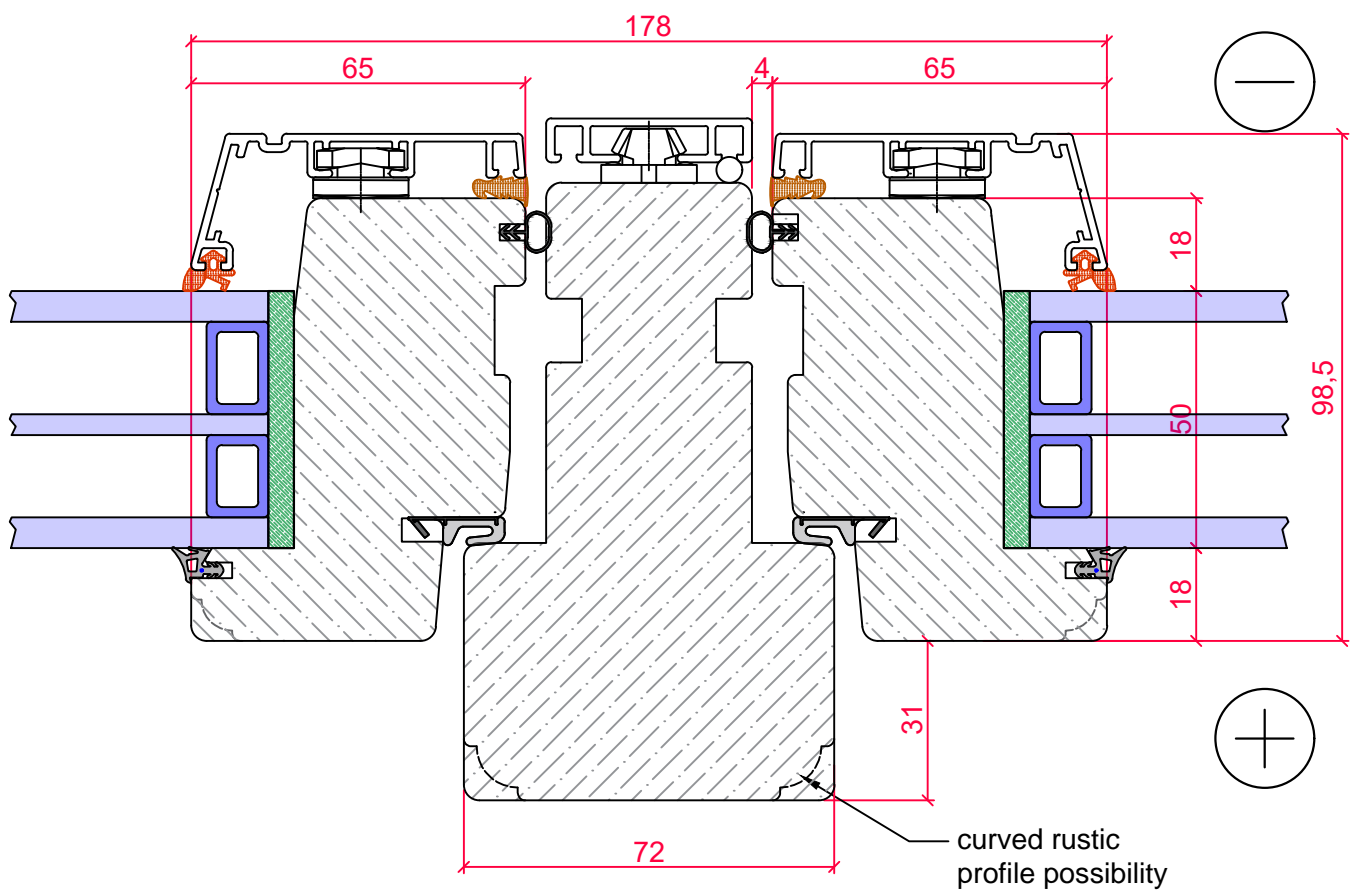

| | | | |
|---|----------------|-----------------------------|---|
| Openable-openable window vertical post cut - M7 | | | |
| FAIL U:\Konstrueerimine\Konstrueerimise projektid 2021\TAANI AKEN | | | |
| DFRAFT: | VELJO LAANEMÄE | DATE: | 29.09.2023 |
| KOOSKÖLASTAS: | | PROFILE No: | |
| APPROVED: | | | |
| SCALE: 1:1 | | DRAWING NR / SHEET Pos3A | FORMAT: ISO expand A4 (210.00 x 297.00 MM) |

REKMAN

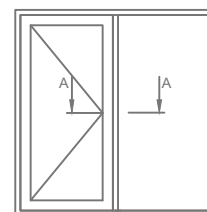
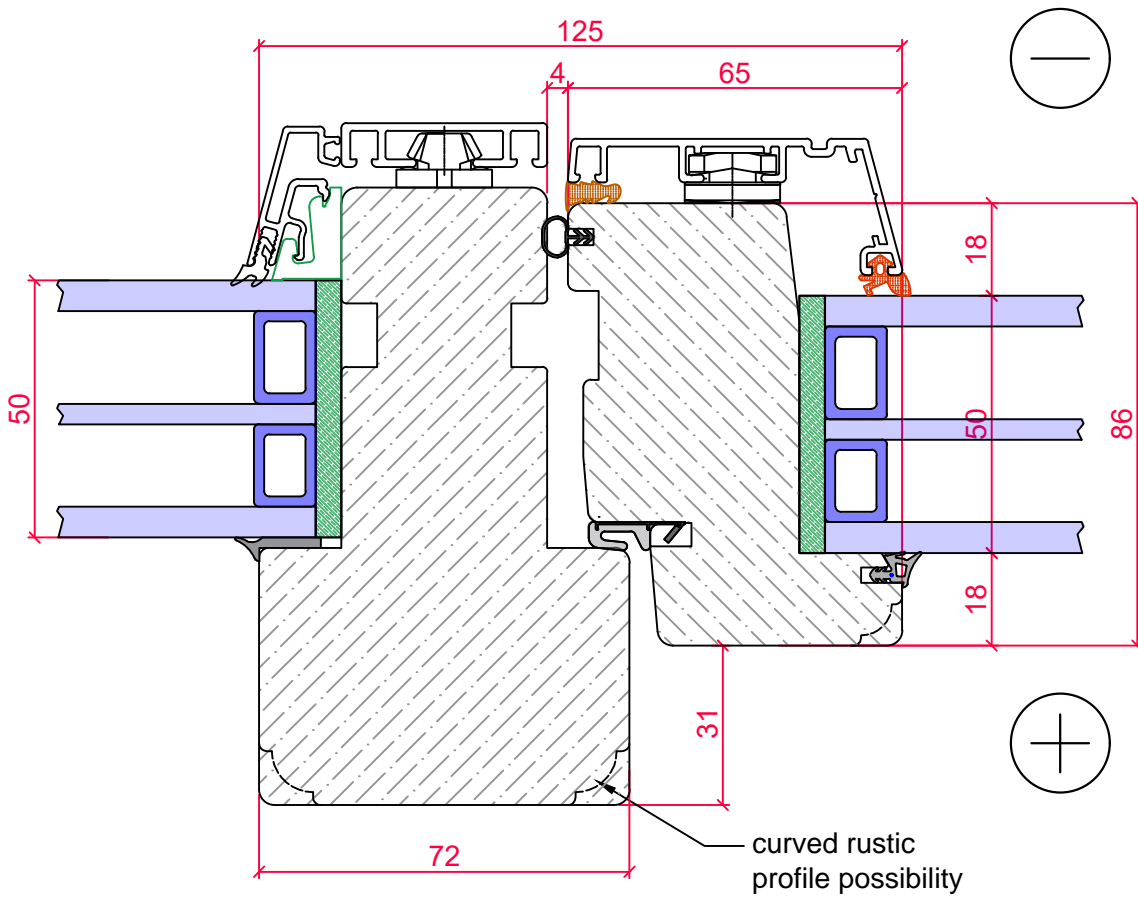

Rekman OÜ
 Reg. Nr. 10093586
 Paneeli 4, 11415 Tallinn
 TEL: 372 601 45 51
 FAX: 372 601 45 59
 E-mail: rekman@rekman.com
 www.rekman.ee



| | | | |
|---|----------------|-----------------------------|---|
| Openable and fixed window vertical post cut - M7 | | | |
| FAIL U:\Konstrueerimine\Konstrueerimise projektid 2021\TAANI AKEN | | | |
| DFRAFT: | VELJO LAANEMÄE | DATE: | 29.09.2023 |
| KOOSKÖLASTAS: | | PROFILE No: | |
| APPROVED: | | | |
| SCALE: 1:1 | | DRAWING NR / SHEET Pos4A | FORMAT: ISO expand A4 (210.00 x 297.00 MM) |

REKMAN

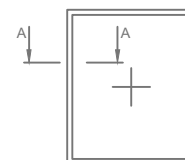
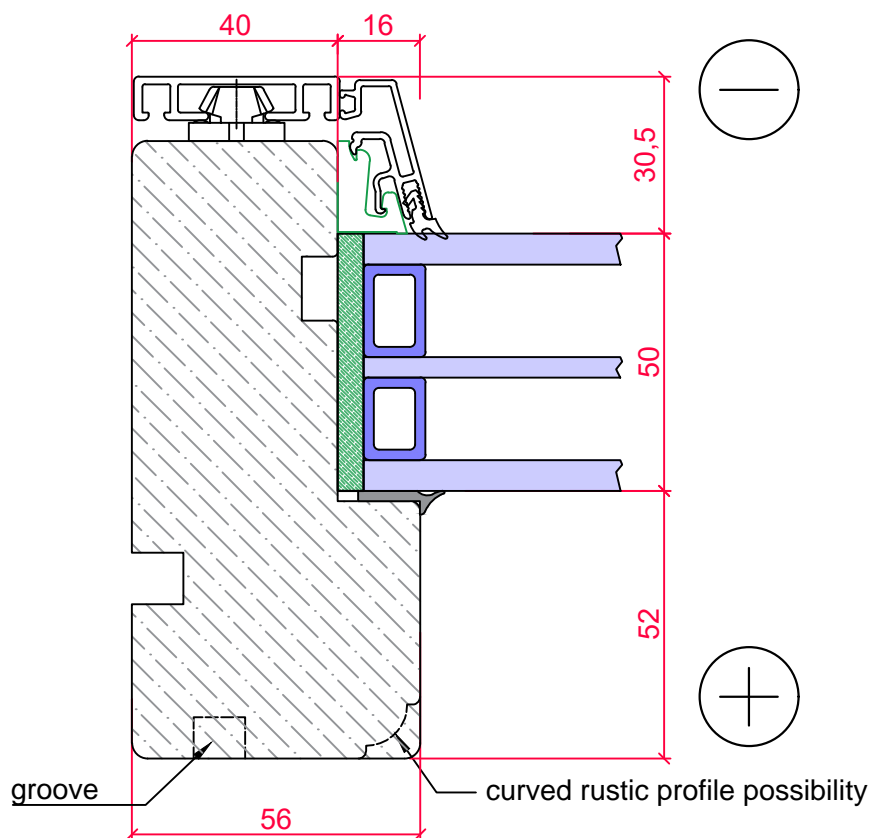
Rekman OÜ
 Reg. Nr. 10093586
 Paneeli 4, 11415 Tallinn
 TEL: 372 601 45 51
 FAX: 372 601 45 59
 E-mail: rekman@rekman.com
 www.rekman.ee



Fixed window side cut - M7

FAIL U:\Konstrueerimine\Konstrueerimise projektid 2021\TAANI AKEN

| | | | |
|---------------|----------------|-----------------------------|---|
| DFRAFT: | VELJO LAANEMÄE | DATE: | 29.09.2023 |
| KOOSKÖLASTAS: | | PROFILE No: | |
| APPROVED: | | | |
| SCALE: 1:1 | | DRAWING NR / SHEET Pos5A | FORMAT: ISO expand A4 (210.00 x 297.00 MM) |

REKMAN

Rekman OÜ
 Reg. Nr. 10093586
 Paneeli 4, 11415 Tallinn
 TEL: 372 601 45 51
 FAX: 372 601 45 59
 E-mail: rekman@rekman.com
 www.rekman.ee

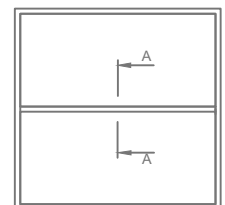
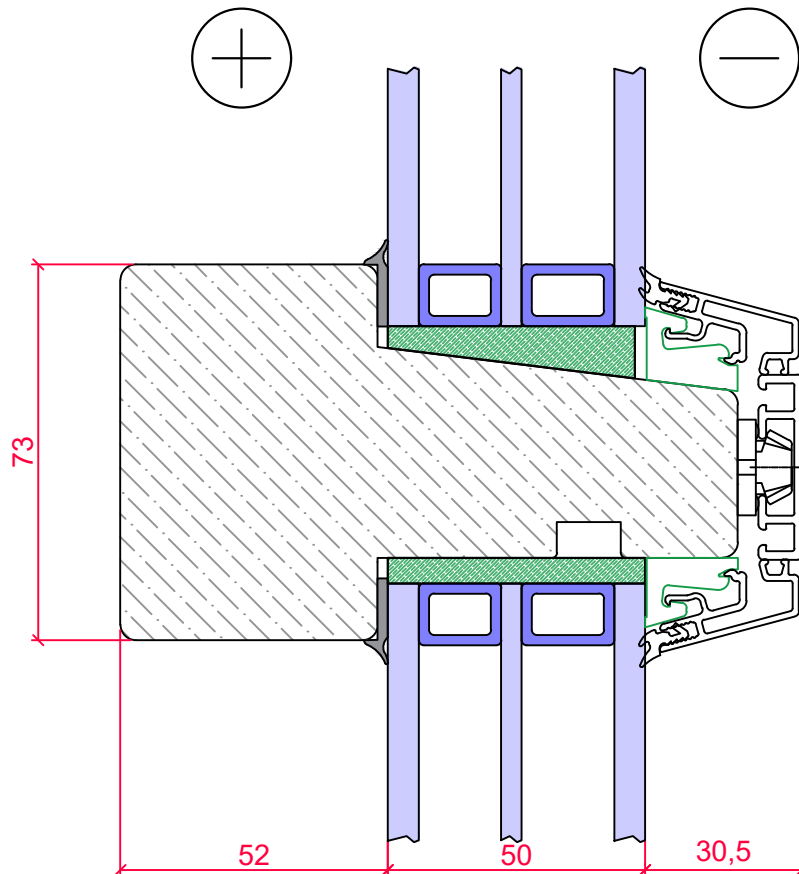

Fixed-fixed window horizontal middle post cut - M7

FAIL U:\Konstrueerimine\Konstrueerimise projektid 2021\TAANI AKEN

| | | | |
|---------------|----------------|-----------------------------|---|
| DFRAFT: | VELJO LAANEMÄE | DATE: | 29.09.2023 |
| KOOSKÖLASTAS: | | PROFILE No: | |
| APPROVED: | | | |
| SCALE: 1:1 | | DRAWING NR / SHEET Pos6A | FORMAT: ISO expand A4 (210.00 x 297.00 MM) |

REKMAN

TINGIMA TÄHTSUD AJAKAD JA VEENUD

Rekman OÜ
 Reg. Nr. 10093586
 Paneeli 4, 11415 Tallinn
 TEL: 372 601 45 51
 FAX: 372 601 45 59
 E-mail: rekman@rekman.com
 www.rekman.ee

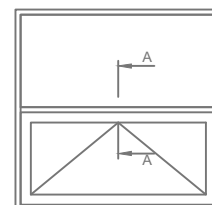
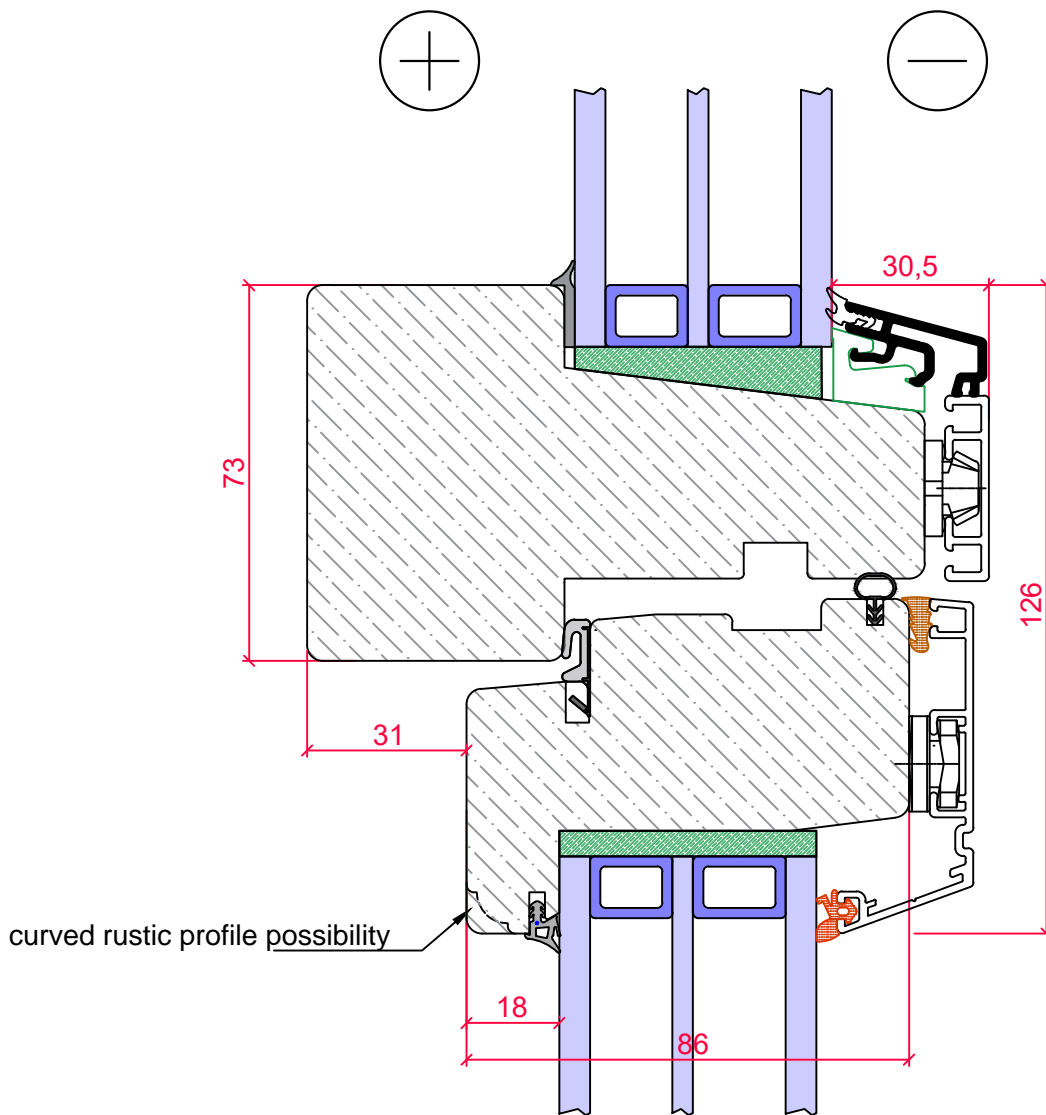

| Fixed-openable window horizontal middle post cut - M7 | | | |
|---|----------------|-----------------------------|---|
| FAIL U:\Konstrueerimine\Konstrueerimise projektid 2021\TAANI AKEN | | | |
| DFRAFT: | VELJO LAANEMÄE | DATE: | 29.09.2023 |
| KOOSKÖLASTAS: | | PROFILE No: | |
| APPROVED: | | | |
| SCALE: 1:1 | | DRAWING NR / SHEET Pos7A | FORMAT: ISO expand A4 (210.00 x 297.00 MM) |

REKMAN

TINGIMA TÄHTSUD AJAKAD JA VÄRVID

Rekman OÜ
 Reg. Nr. 10093586
 Paneeli 4, 11415 Tallinn
 TEL: 372 601 45 51
 FAX: 372 601 45 59
 E-mail: rekman@rekman.com
 www.rekman.ee

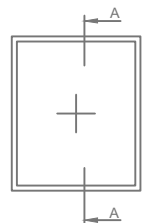
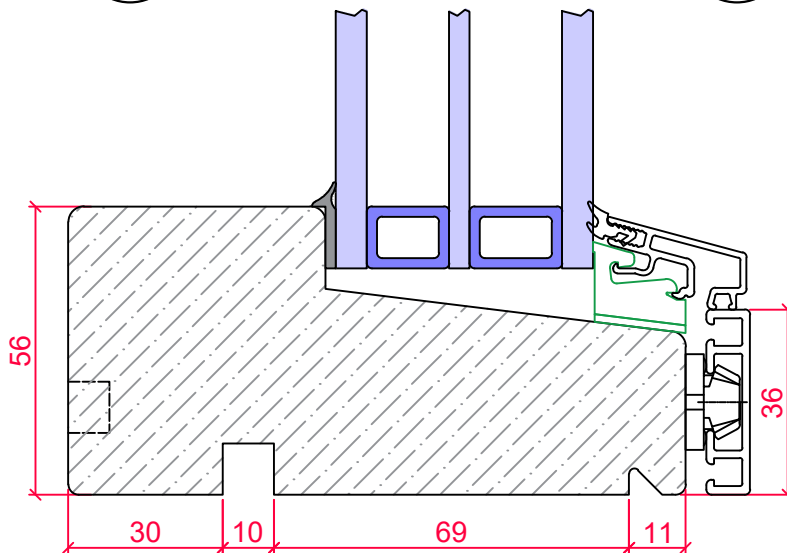
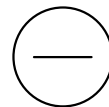
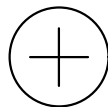
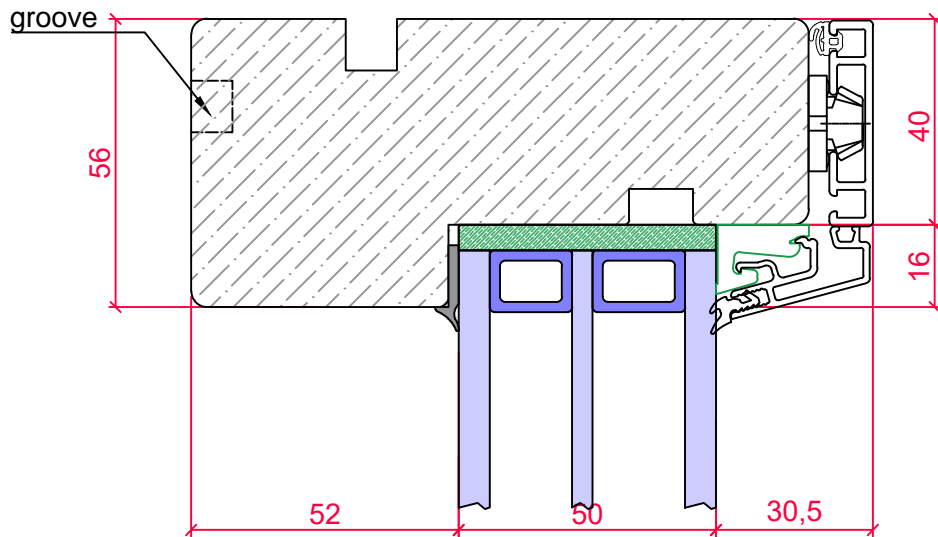

Fixed window lower and upper
frame cut - M7

FAIL U:\Konstrueerimine\Konstrueerimise projektid 2021\TAANI AKEN

| | | | |
|---------------|----------------|-----------------------------|---|
| DFRAFT: | VELJO LAANEMÄE | DATE: | 29.09.2023 |
| KOOSKÖLASTAS: | | PROFILE No: | |
| APPROVED: | | | |
| SCALE: 1:1 | | DRAWING NR / SHEET Pos8A | FORMAT: ISO expand A4 (210.00 x 297.00 MM) |

REKMAN

Rekman OÜ
 Reg. Nr. 10093586
 Paneeli 4, 11415 Tallinn
 TEL: 372 601 45 51
 FAX: 372 601 45 59
 E-mail: rekman@rekman.com
 www.rekman.ee

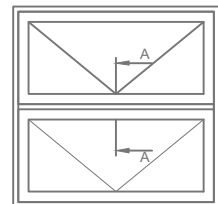
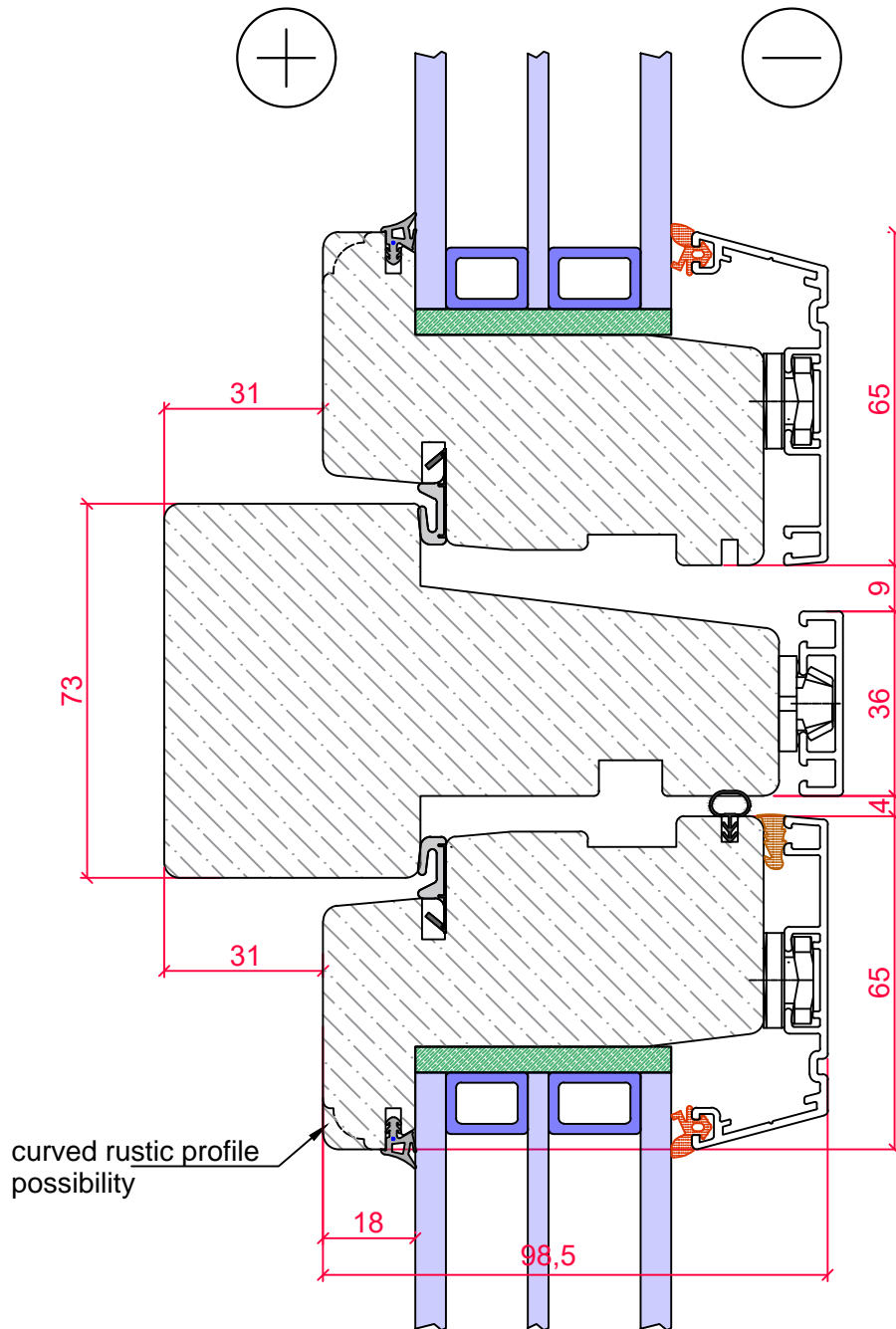

| Openable-openable window horizontal middle post cut - M7 | | | |
|---|----------------|-----------------------------|---|
| FAIL U:\Konstueerimine\Konstueerimise projektid 2021\TAANI AKEN | | | |
| DFRAFT: | VELJO LAANEMÄE | DATE: | 29.09.2023 |
| KOOSKÖLASTAS: | | PROFILE No: | |
| APPROVED: | | | |
| SCALE: 1:1 | | DRAWING NR / SHEET Pos9A | FORMAT: ISO expand A4 (210.00 x 297.00 MM) |

REKMAN

REKMAN OÜ

Reg. Nr. 10093586
 Paneeli 4, 11415 Tallinn
 TEL: 372 601 45 51
 FAX: 372 601 45 59
 E-mail: rekman@rekman.com
 www.rekman.ee

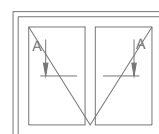
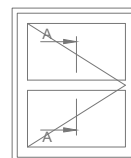
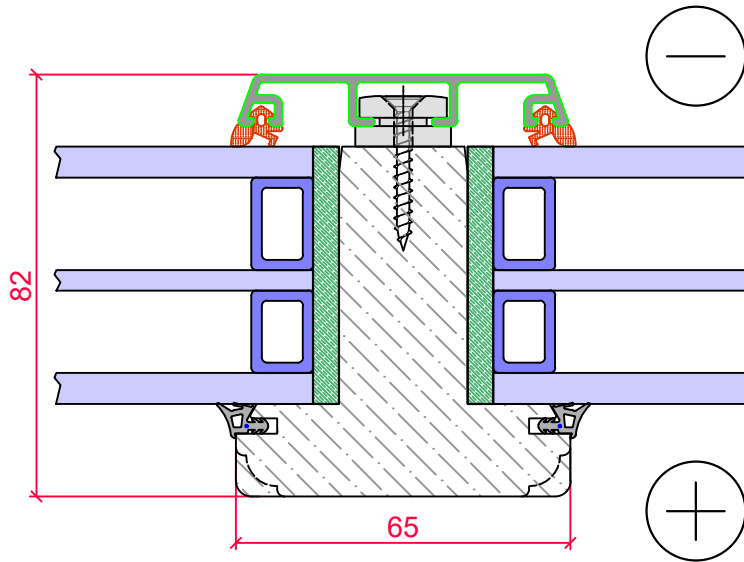
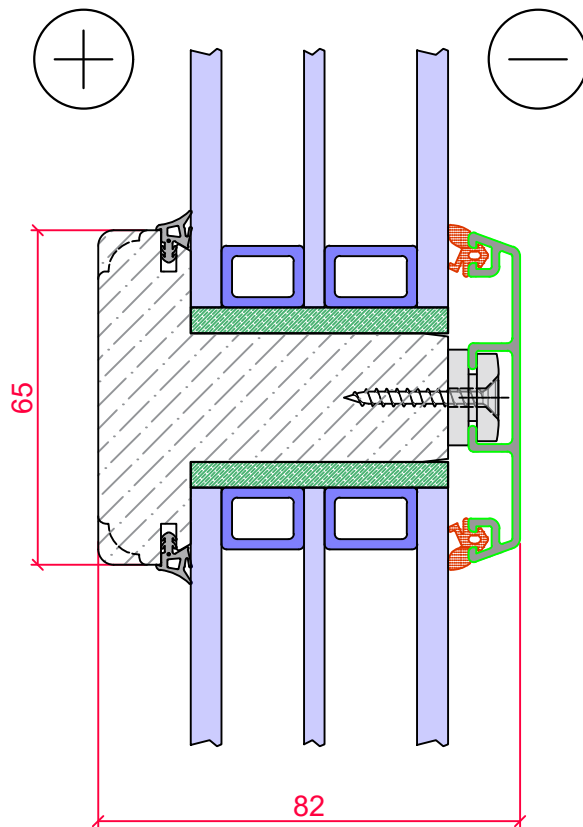

Openable sash muntins cut - M7

FAIL U:\Konstrueerimine\Konstrueerimise projektid 2021\TAANI AKEN

| | | | |
|---------------|----------------|------------------------------|---|
| DFRAFT: | VELJO LAANEMÄE | DATE: | 29.09.2023 |
| KOOSKÖLASTAS: | | PROFILE No: | |
| APPROVED: | | | |
| SCALE: 1:1 | | DRAWING NR / SHEET Pos10A | FORMAT: ISO expand A4 (210.00 x 297.00 MM) |

REKMAN

Rekman OÜ
 Reg. Nr. 10093586
 Paneeli 4, 11415 Tallinn
 TEL: 372 601 45 51
 FAX: 372 601 45 59
 E-mail: rekman@rekman.com
 www.rekman.ee