

Outwards-opening wooden window DW-120

Frame: 120x56mm

Sash thickness: 90mm

Wood: Finger jointed pine; oak; meranti, accoya

Finishing: RAL catalogue; Teknos stains

Glazing unit thickness: 50mm

Fitting system: AURA

Openings:

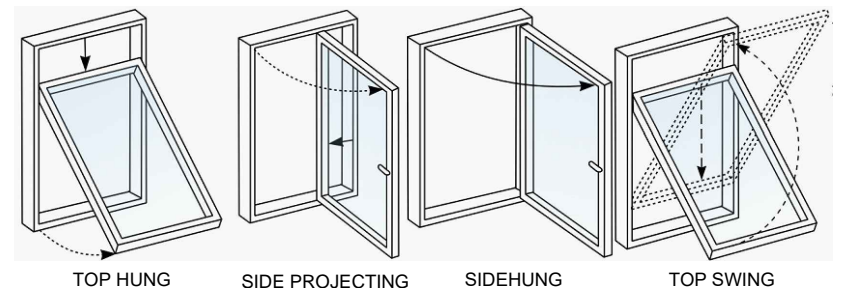

OBJEKT: Outwards-opening wooden
DW120 window - AURA fitting system

FAIL: U:\Konstrueerimine\Konstrueerimise projektid 2021\TAANI AKEN\Välja avanev Taani aken			
KOOSTAS:	Veljo Laanemäe		29.09.2023
MUUTIS:		EN ISO 9001:2000 dok nr:	KEP-11 V01
KOOSKÖLASTAS:		STAADIUM:	tööprojekt
MASTAAP:	Joonis: 1:1,5	Puit aken Mila AURA	Formaat: A3

REKMAN
KINGIMA TEHTUD AKNAD JA UKSED

Rekman OÜ
Reg.Nr.10093586
EH10093586-0001 ; EP10093586-0001
Paneeli 4 ,11415 Tallinn
TEL: 372 601 45 51
FAX: 372 601 45 59
E-mail: rekman@rekman.com
www.rekman.ee

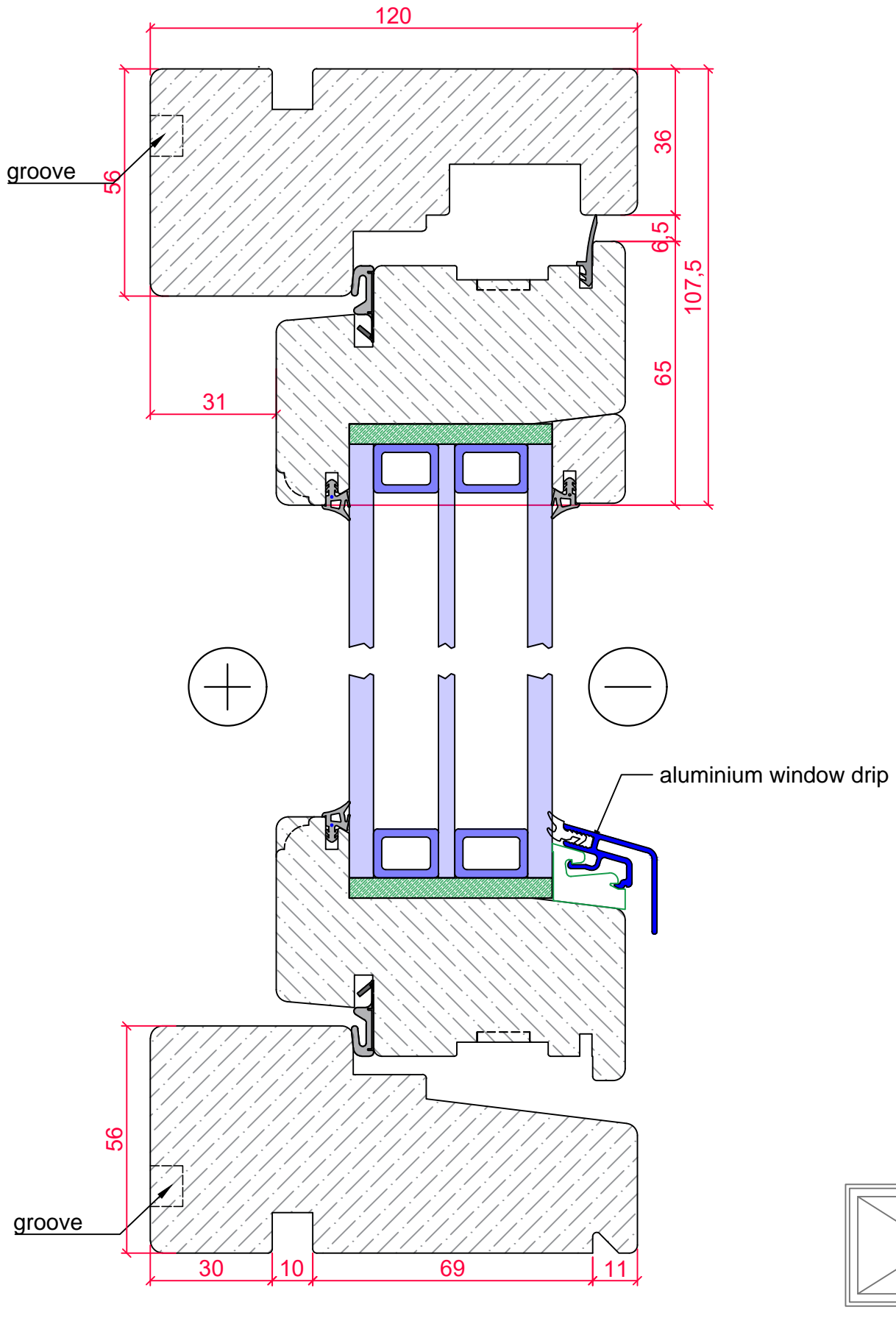

Openable window upper and lower cut - Mila AURA			
FAIL U:\Konstrueerimine\Konstrueerimise projektid 2021\ITAANI AKEN			
DFRAFT:	VELJO LAANEMÄE	DATE:	29.09.2023
KOOSKÖLASTAS:		PROFILE No:	
APPROVED:			
SCALE: 1:1		DRAWING NR / SHEET Pos11	FORMAT: ISO full bleed A4 (210.00 x 297.00 MM)



Rekman OÜ
 Reg. Nr. 10093586
 Paneeli 4, 11415 Tallinn
 TEL: 372 601 45 51
 FAX: 372 601 45 59
 E-mail: rekman@rekman.com
 www.rekman.ee

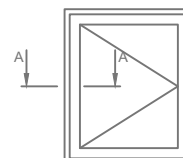
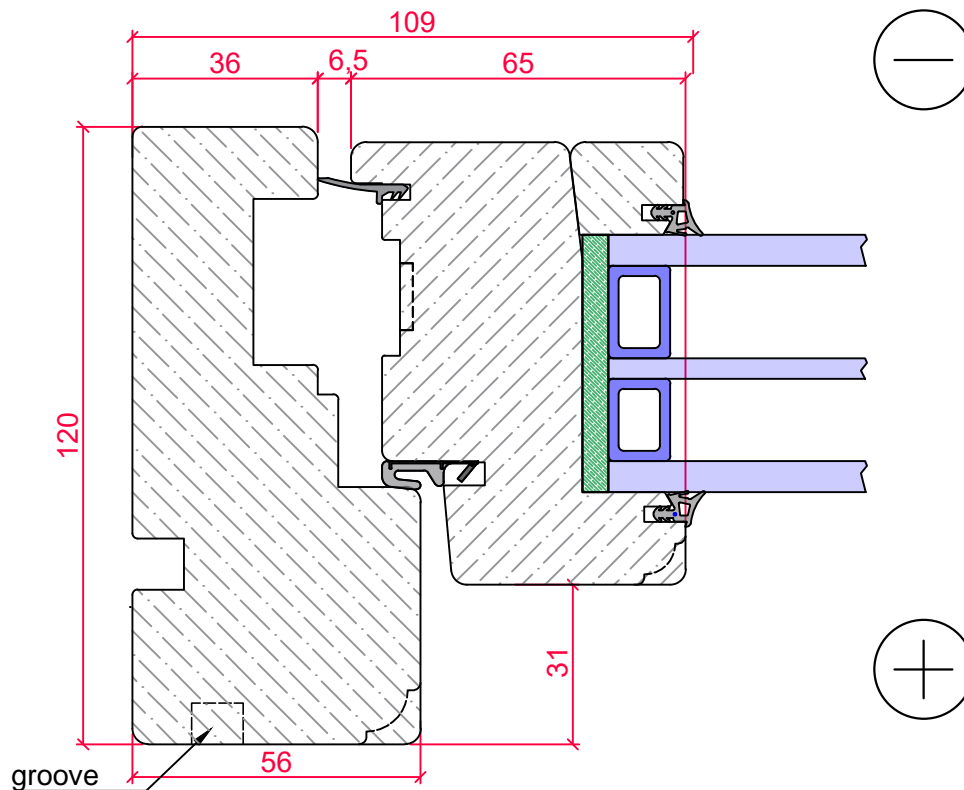

Openable window side cut - Mila AURA

FAIL U:\Konstrueerimine\Konstrueerimise projektid 2021\TAANI AKEN

DFRAFT:	VELJO LAANEMÄE	DATE:	29.09.2023
KOOSKÖLASTAS:		PROFILE No:	
APPROVED:			
SCALE: 1:1		DRAWING NR / SHEET Pos22	FORMAT: ISO expand A4 (210.00 x 297.00 MM)

REKMAN

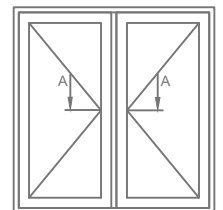
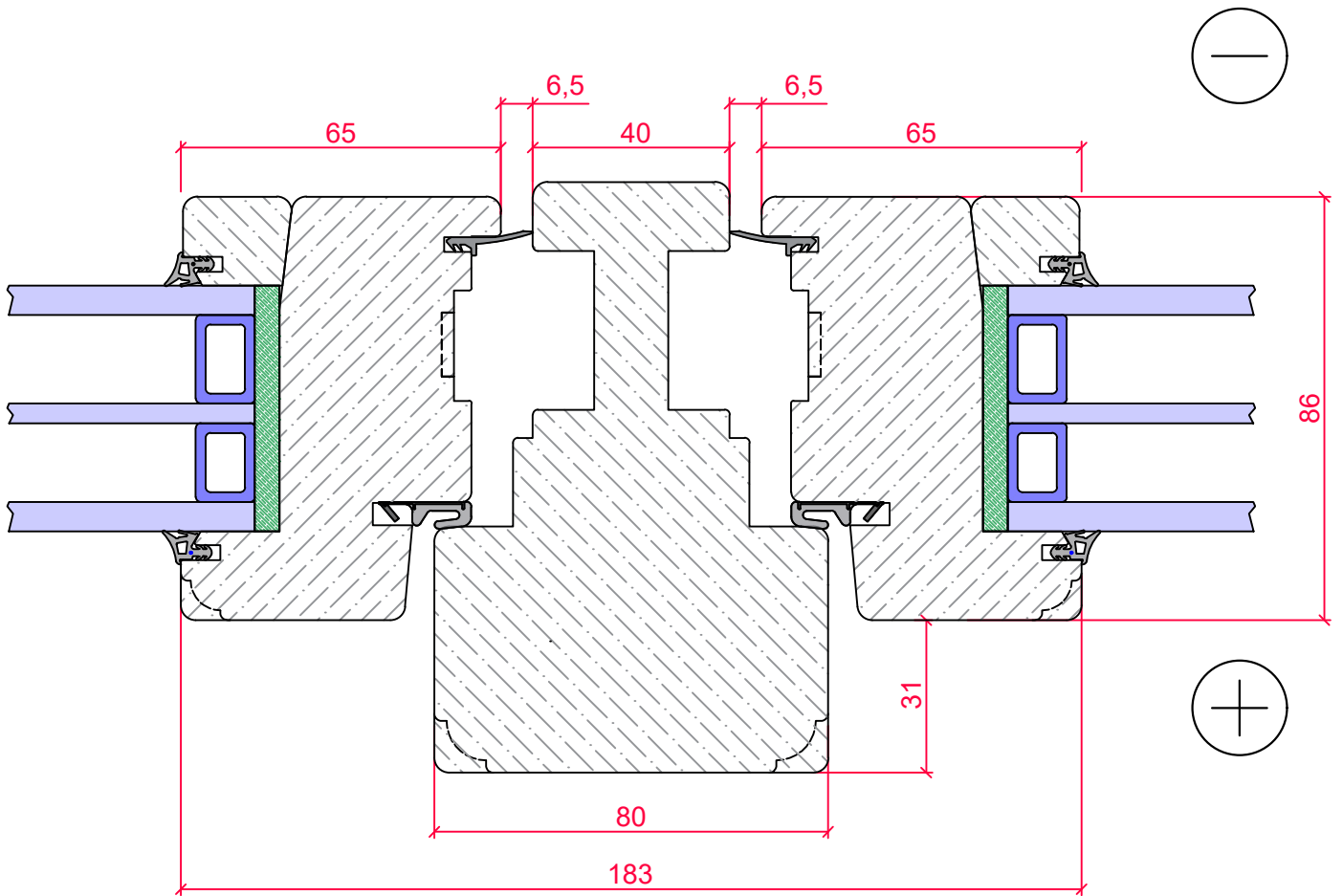

Rekman OÜ
 Reg. Nr. 10093586
 Paneeli 4, 11415 Tallinn
 TEL: 372 601 45 51
 FAX: 372 601 45 59
 E-mail: rekman@rekman.com
 www.rekman.ee



Openable-openable window vertical middle post cut - Mila AURA			
FAIL U:\Konstrueerimine\Konstrueerimise projektid 2021\TAANI AKEN			
DFRAFT:	VELJO LAANEMÄE	DATE:	29.09.2023
KOOSKÖLASTAS:		PROFILE No:	
APPROVED:			
SCALE: 1:1		DRAWING NR / SHEET Pos33	FORMAT: ISO expand A4 (210.00 x 297.00 MM)

REKMAN

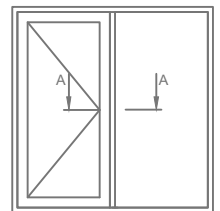
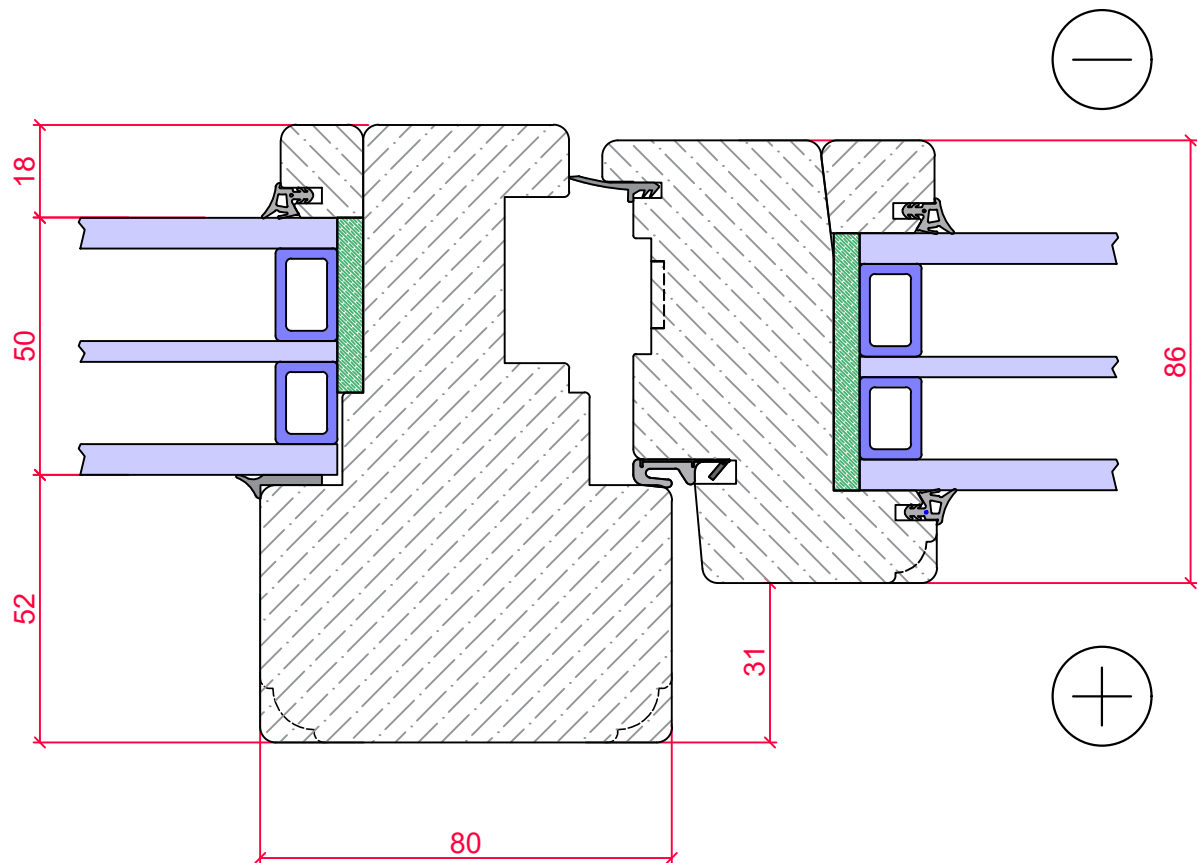

Rekman OÜ
 Reg. Nr. 10093586
 Paneeli 4, 11415 Tallinn
 TEL: 372 601 45 51
 FAX: 372 601 45 59
 E-mail: rekman@rekman.com
 www.rekman.ee



Openable-fixed window vertical middle post cut - M7			
FAIL: U:\Konstrueerimine\Konstrueerimise projektid 2021\TAANI AKEN			
DFRAFT:	VELJO LAANEMÄE	DATE:	29.09.2023
KOOSKÖLASTAS:		PROFILE No:	
APPROVED:			
SCALE: 1:1		DRAWING NR / SHEET Pos44	FORMAT: ISO expand A4 (210.00 x 297.00 MM)

REKMAN

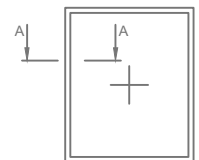
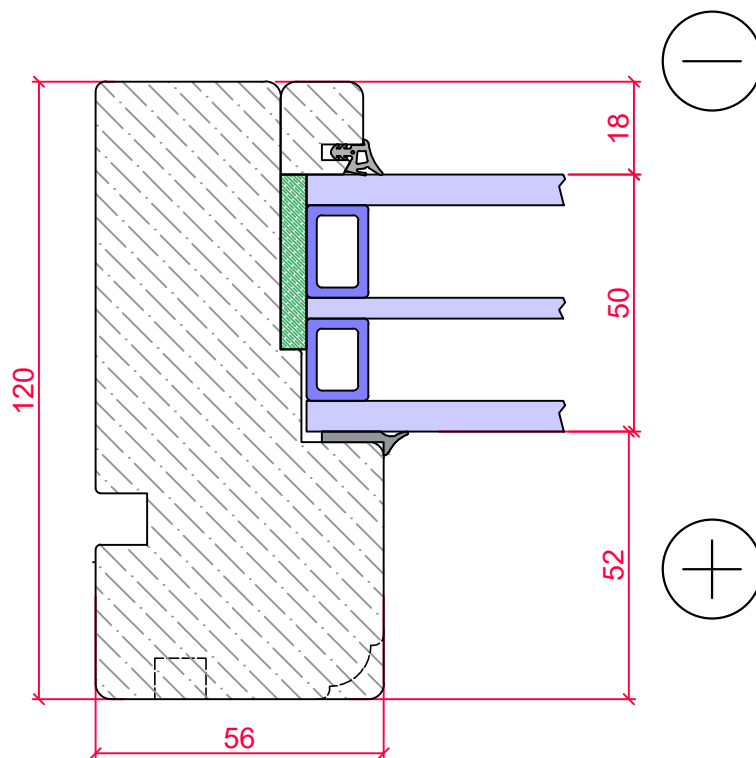
Rekman OÜ
 Reg. Nr. 10093586
 Paneeli 4, 11415 Tallinn
 TEL: 372 601 45 51
 FAX: 372 601 45 59
 E-mail: rekman@rekman.com
 www.rekman.ee



Fixed window frame side cut - Mila AURA

FAIL U:\Konstrueerimine\Konstrueerimise projektid 2021\TAANI AKEN

DFRAFT:	VELJO LAANEMÄE	DATE:	29.09.2023
KOOSKÖLASTAS:		PROFILE No:	
APPROVED:			
SCALE: 1:1		DRAWING NR / SHEET Pos55	FORMAT: ISO expand A4 (210.00 x 297.00 MM)

REKMAN
 **TINGIMA TEEVUD AJAKAD JA VÕRUD** 

Rekman OÜ
 Reg. Nr. 10093586
 Paneeli 4, 11415 Tallinn
 TEL: 372 601 45 51
 FAX: 372 601 45 59
 E-mail: rekman@rekman.com
 www.rekman.ee

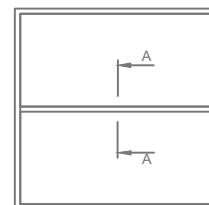
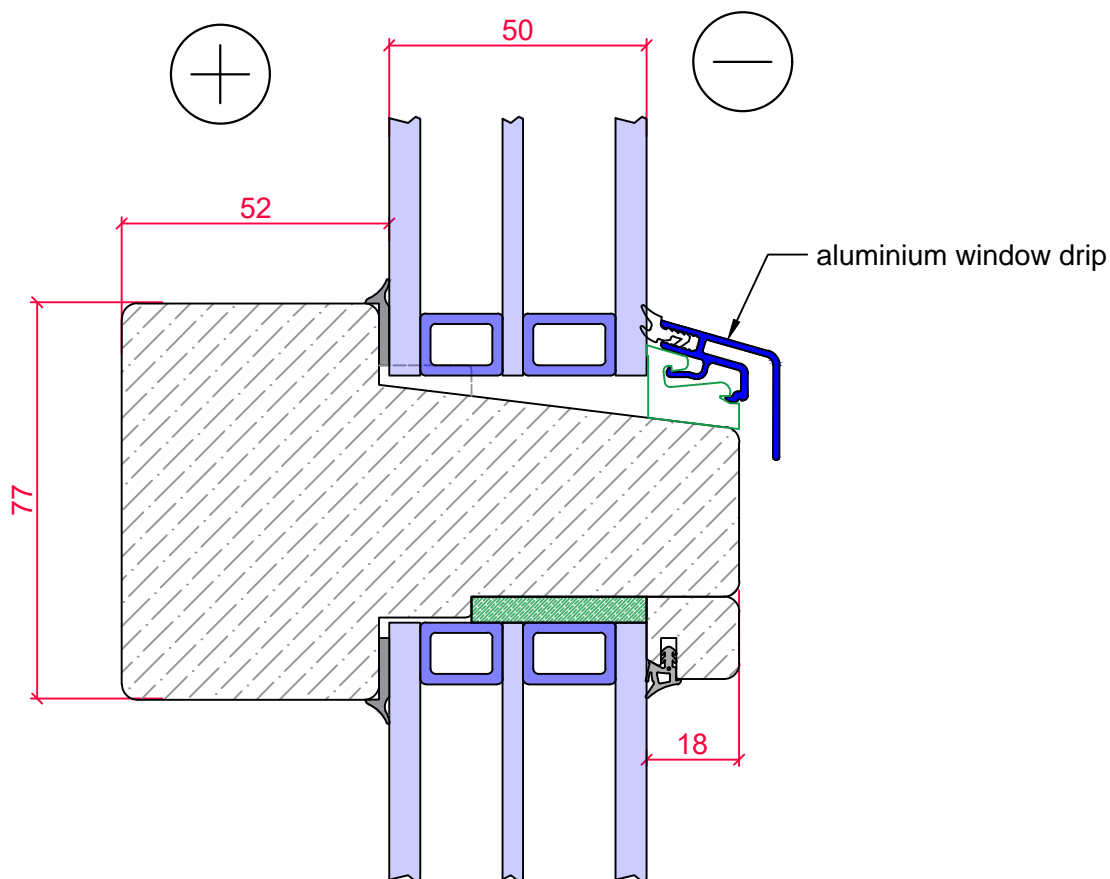

Fixed-fixed window dividing horizontal post cut - Mila AURA

FAIL U:\Konstrueerimine\Konstrueerimise projektid 2021\TAANI AKEN

DFRAFT:	VELJO LAANEMÄE	DATE:	29.09.2023
KOOSKÖLASTAS:		PROFILE No:	
APPROVED:			
SCALE: 1:1		DRAWING NR / SHEET Pos66	FORMAT: ISO expand A4 (210.00 x 297.00 MM)

REKMAN

TINGIMA TÄHTSUD AJAKAD JA ÜHEND

Rekman OÜ
 Reg. Nr. 10093586
 Paneeli 4, 11415 Tallinn
 TEL: 372 601 45 51
 FAX: 372 601 45 59
 E-mail: rekman@rekman.com
 www.rekman.ee

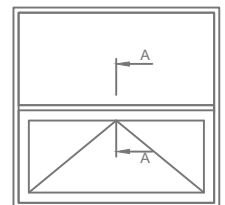
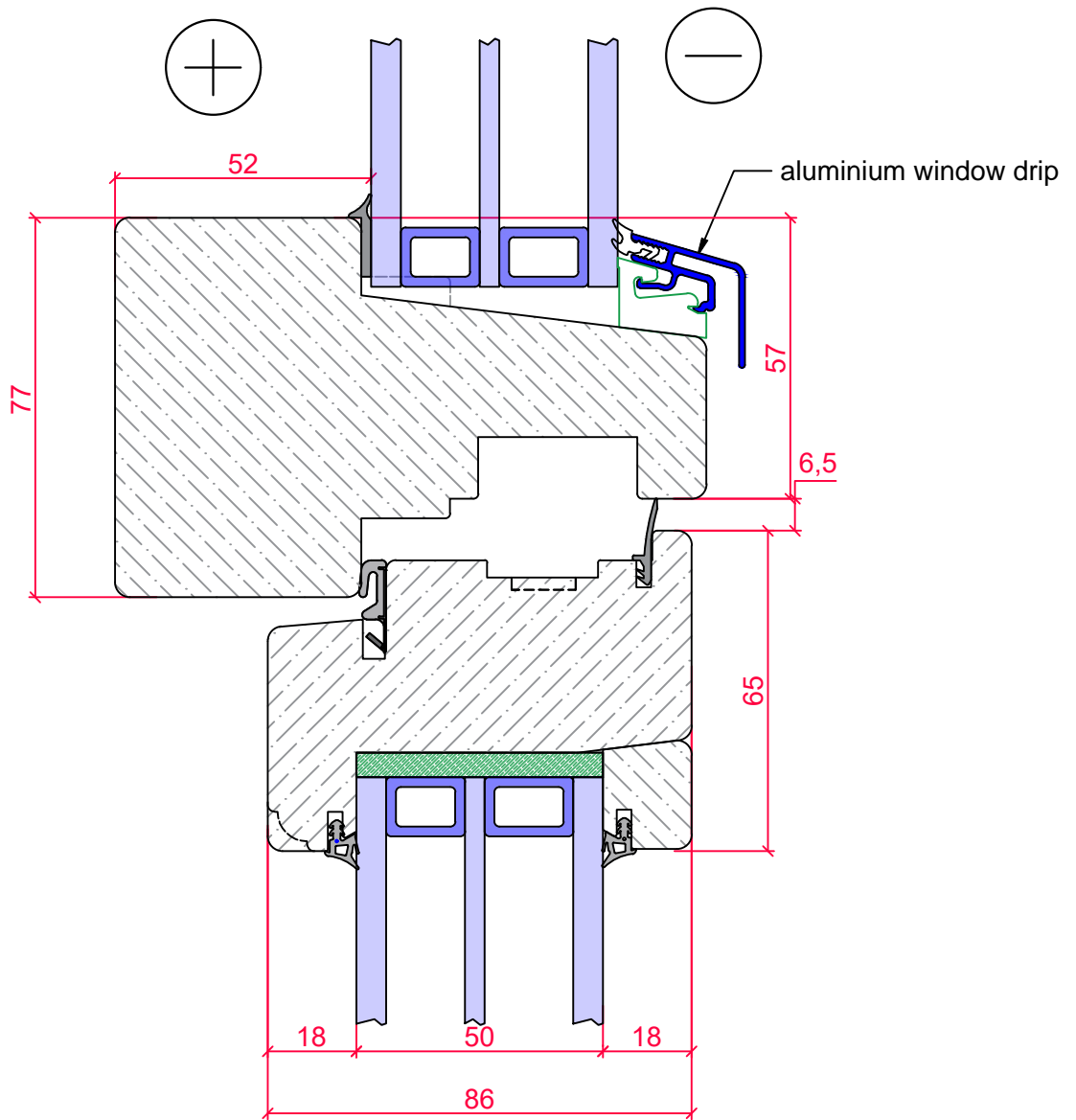

Openable-fixed dividing horizontal post cut -
Mila AURA

FAIL U:\Konstreeerimine\Konstreeerimise projektid 2021\TAANI AKEN

DFRAFT:	VELJO LAANEMÄE	DATE:	29.09.2023
KOOSKÖLASTAS:		PROFILE No:	
APPROVED:			
SCALE: 1:1		DRAWING NR / SHEET Pos77	FORMAT: ISO expand A4 (210.00 x 297.00 MM)

REKMAN

TINGIGAS TÄHTSAD AJAKAD JA UHED

Rekman OÜ
 Reg. Nr. 10093586
 Paneeli 4, 11415 Tallinn
 TEL: 372 601 45 51
 FAX: 372 601 45 59
 E-mail: rekman@rekman.com
 www.rekman.ee

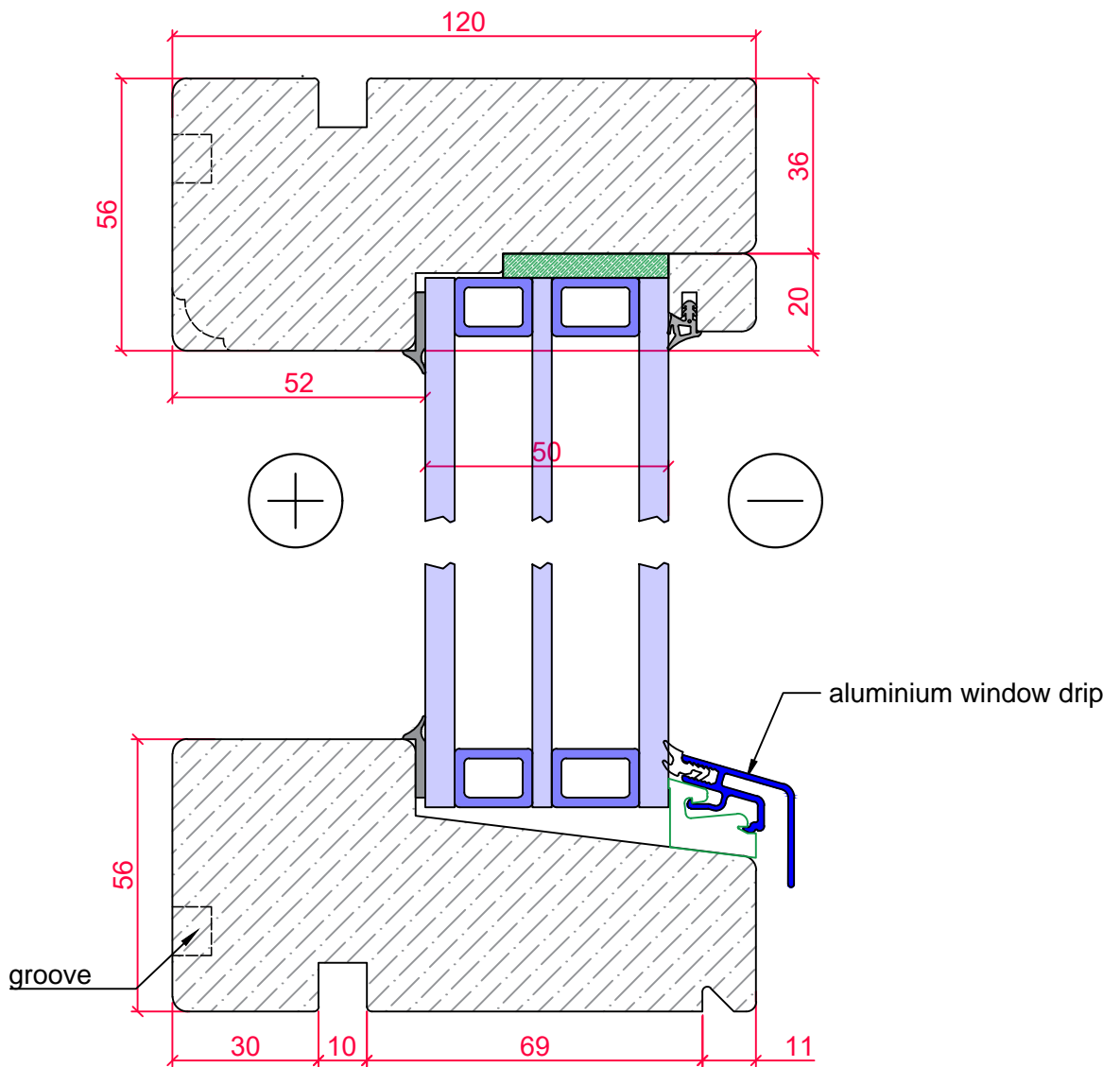

Fixed window upper and lower frame cut - Mila AURA			
FAIL U:\Konstrueerimine\Konstrueerimise projektid 2021\TAANI AKEN			
DFRAFT:	VELJO LAANEMÄE	DATE:	29.09.2023
KOOSKÖLASTAS:		PROFILE No:	
APPROVED:			
SCALE: 1:1		DRAWING NR / SHEET Pos88	FORMAT: ISO expand A4 (210.00 x 297.00 MM)

REKMAN

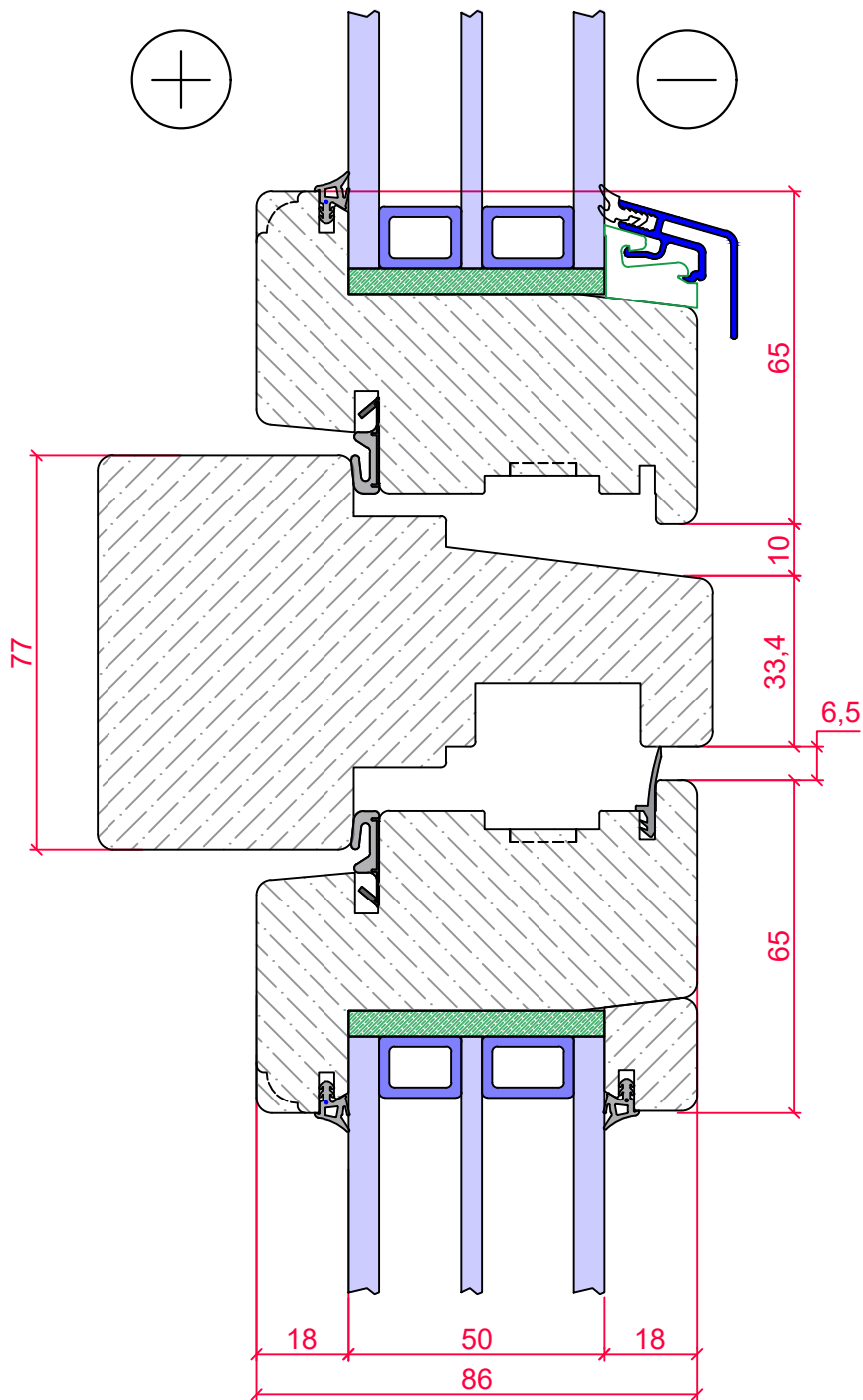

Rekman OÜ
 Reg. Nr. 10093586
 Paneeli 4, 11415 Tallinn
 TEL: 372 601 45 51
 FAX: 372 601 45 59
 E-mail: rekman@rekman.com
 www.rekman.ee



Openable-openable horizontal dividing
post cut M7

FAIL U:\Konstrueerimine\Konstrueerimise projektid 2021\TAANI AKEN

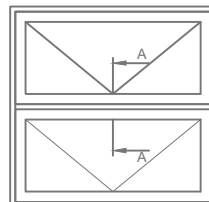
DFRAFT:	VELJO LAANEMÄE	DATE:	29.09.2023
KOOSKÖLASTAS:		PROFILE No:	
APPROVED:			
SCALE: 1:1		DRAWING NR / SHEET Pos99	FORMAT: ISO expand A4 (210.00 x 297.00 MM)



REKMAN

Rekman OÜ
 Reg. Nr. 10093586
 Paneeli 4, 11415 Tallinn
 TEL: 372 601 45 51
 FAX: 372 601 45 59
 E-mail: rekman@rekman.com
 www.rekman.ee

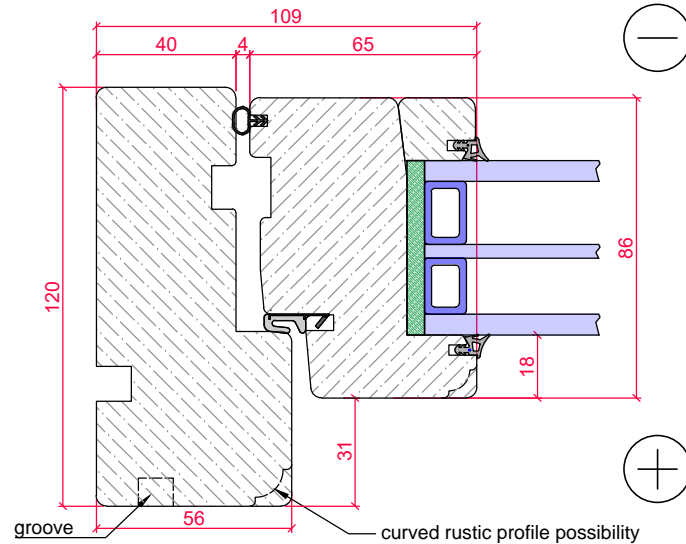
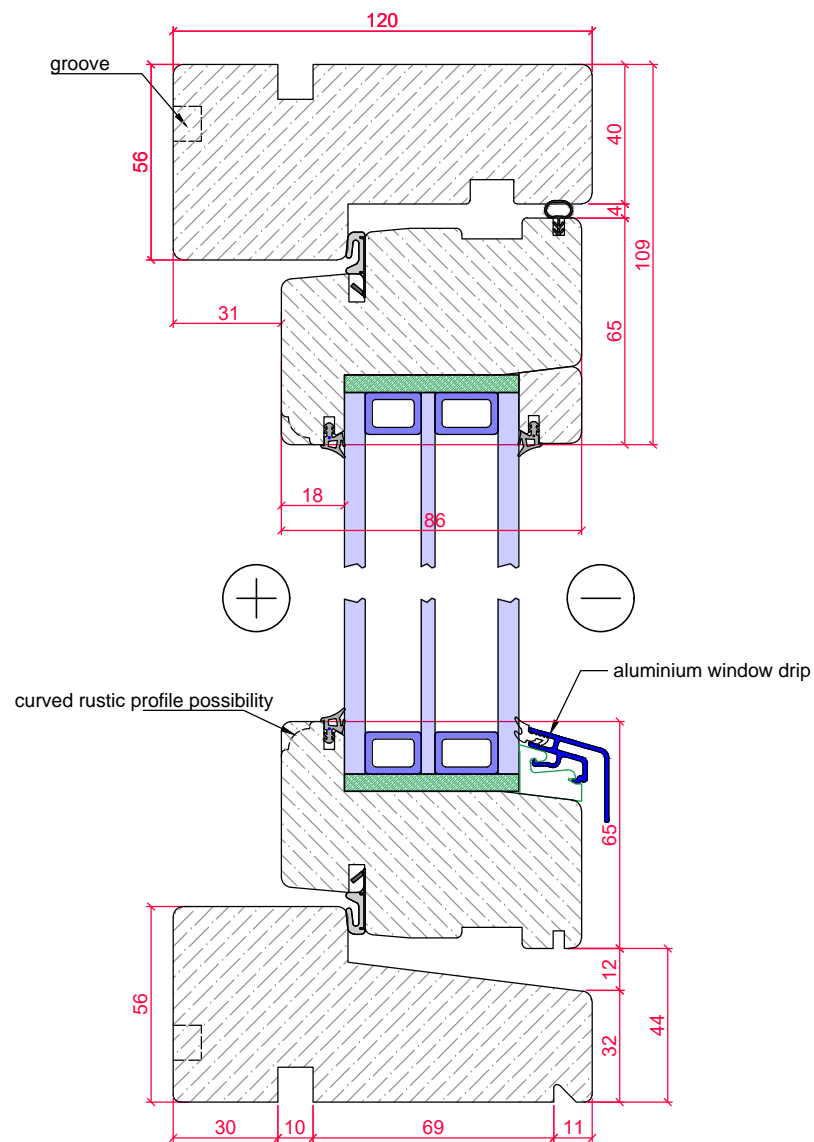

Outwards-opening wooden window DW-120

Frame: 120x56mm
 Sash thickness: 90mm
 Wood: Finger jointed pine; oak; meranti, accoya
 Finishing: RAL catalogue; Teknos stains
 Glazing unit thickness: 50mm
 Fitting system: Mila M7
 Openings:

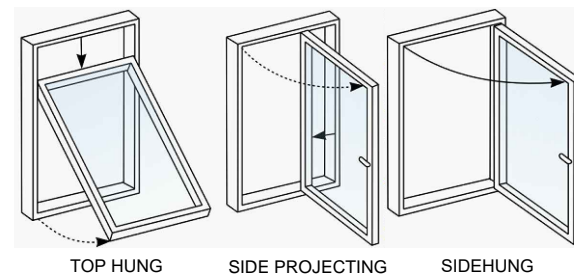

OBJEKT:		Outwards opening wooden DW-120 window - M7 fitting system		 <p> Rekman OÜ Reg.Nr.10093586 EH10093586-0001 ; EP10093586-0001 Paneeli 4, 11415 Tallinn TEL: 372 601 45 51 FAX: 372 601 45 59 E-mail: rekman@rekman.com www.rekman.ee </p>
FAIL:		U:\Konstrueerimine\Konstrueerimise projektid 2021\TAANI AKEN\Wälja avanev Taani aken		
KOOSTAS:	Veljo Laanemäe		29.09.2023	
MUUTIS:		EN ISO 9001:2000 dok nr:	KEP-11 V01	
KOOSKÖLASTAS:		STAADIUM:	tööprojekt	
MASTAAP:	Joonis: 1:1,5	Puit aken M7	Formaat: A3	

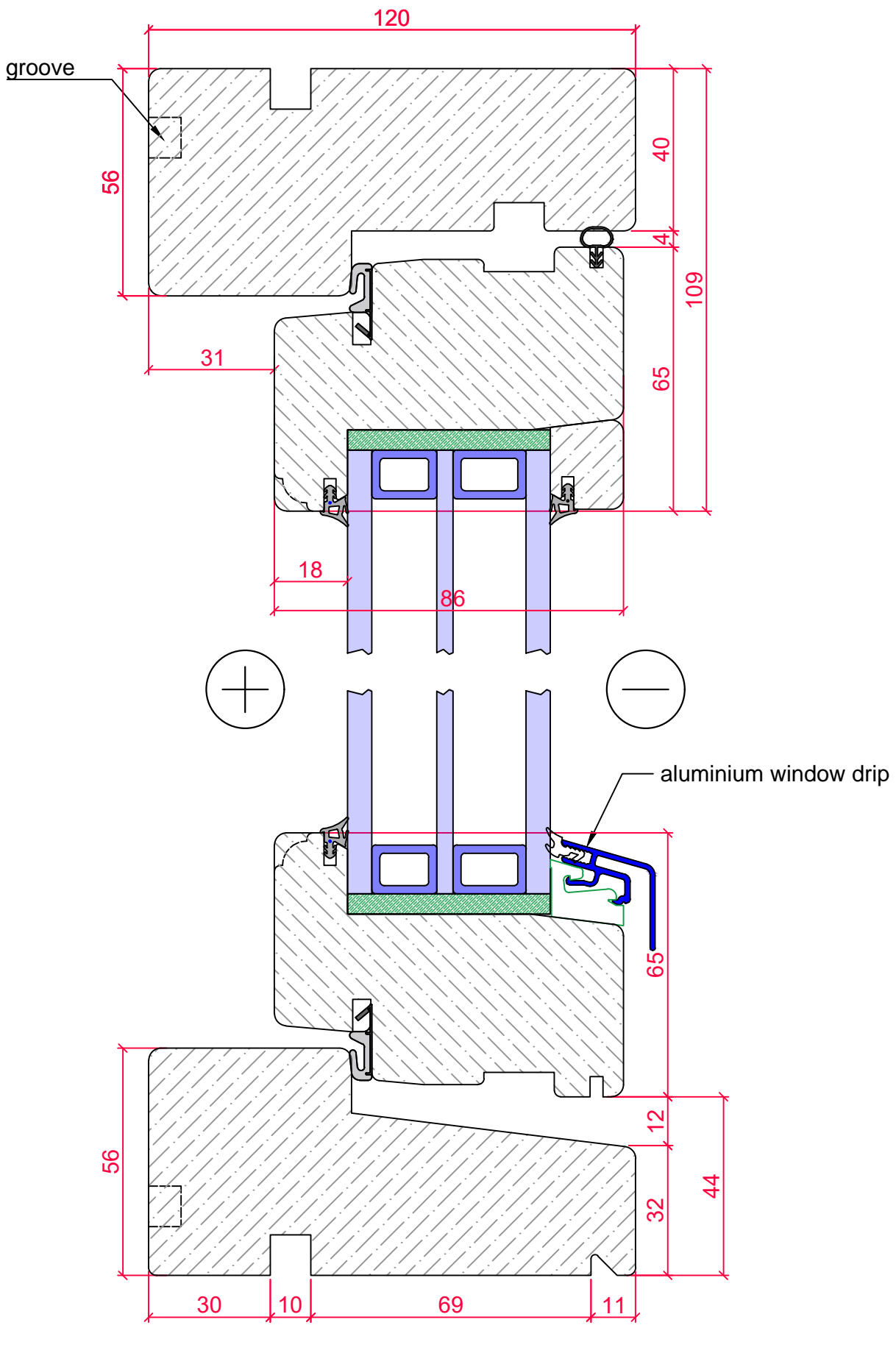

Openable sash upper and lower cut - M7

FAIL U:\Konstrueerimine\Konstrueerimise projektid 2021\ITAANI AKEN

DFRAFT:	VELJO LAANEMÄE	DATE:	29.09.2023
KOOSKÖLASTAS:		PROFILE No:	
APPROVED:			
SCALE: 1:1		DRAWING NR / SHEET Pos1	FORMAT: ISO full bleed A4 (210.00 x 297.00 MM)

REKMAN

Rekman OÜ
 Reg. Nr. 10093586
 Paneeli 4, 11415 Tallinn
 TEL: 372 601 45 51
 FAX: 372 601 45 59
 E-mail: rekman@rekman.com
 www.rekman.ee

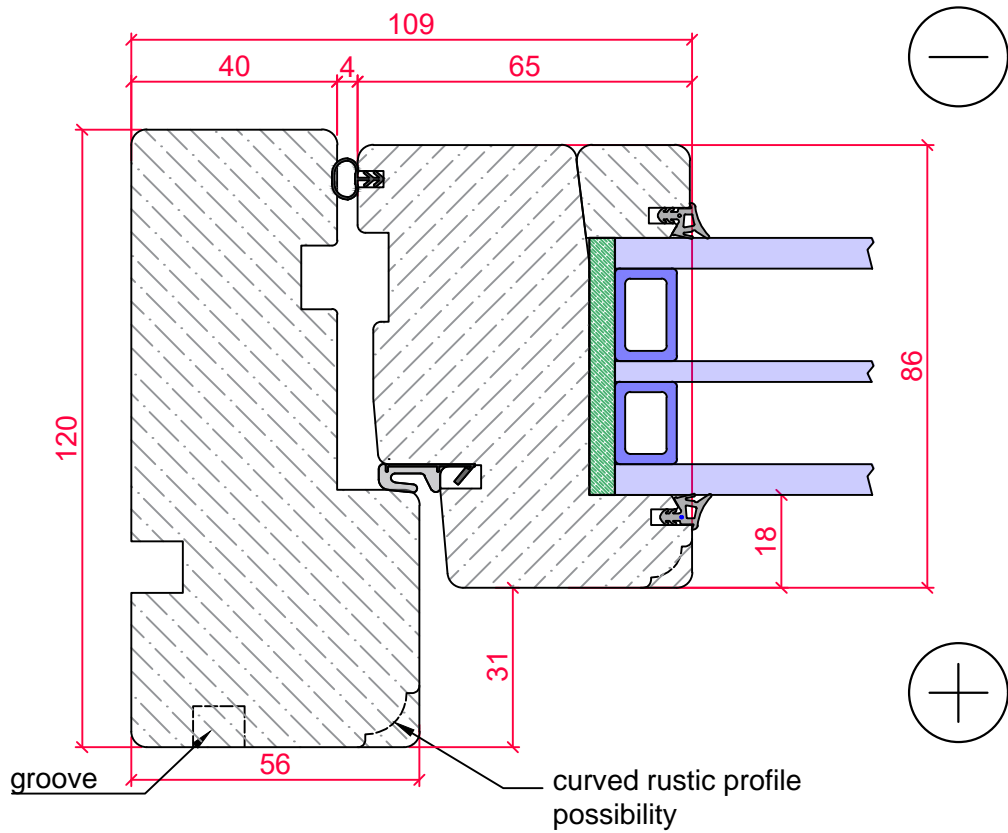

Openable sash vertical side cut - M7

FAIL U:\Konstrueerimine\Konstrueerimise projektid 2021\TAANI AKEN

DFRAFT:	VELJO LAANEMÄE	DATE:	29.09.2023
KOOSKÖLASTAS:		PROFILE No:	
APPROVED:			
SCALE: 1:1		DRAWING NR / SHEET Pos2	FORMAT: ISO expand A4 (210.00 x 297.00 MM)

REKMAN

Rekman OÜ
 Reg. Nr. 10093586
 Paneeli 4, 11415 Tallinn
 TEL: 372 601 45 51
 FAX: 372 601 45 59
 E-mail: rekman@rekman.com
 www.rekman.ee

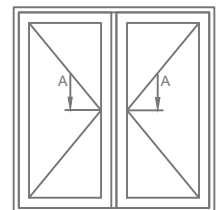
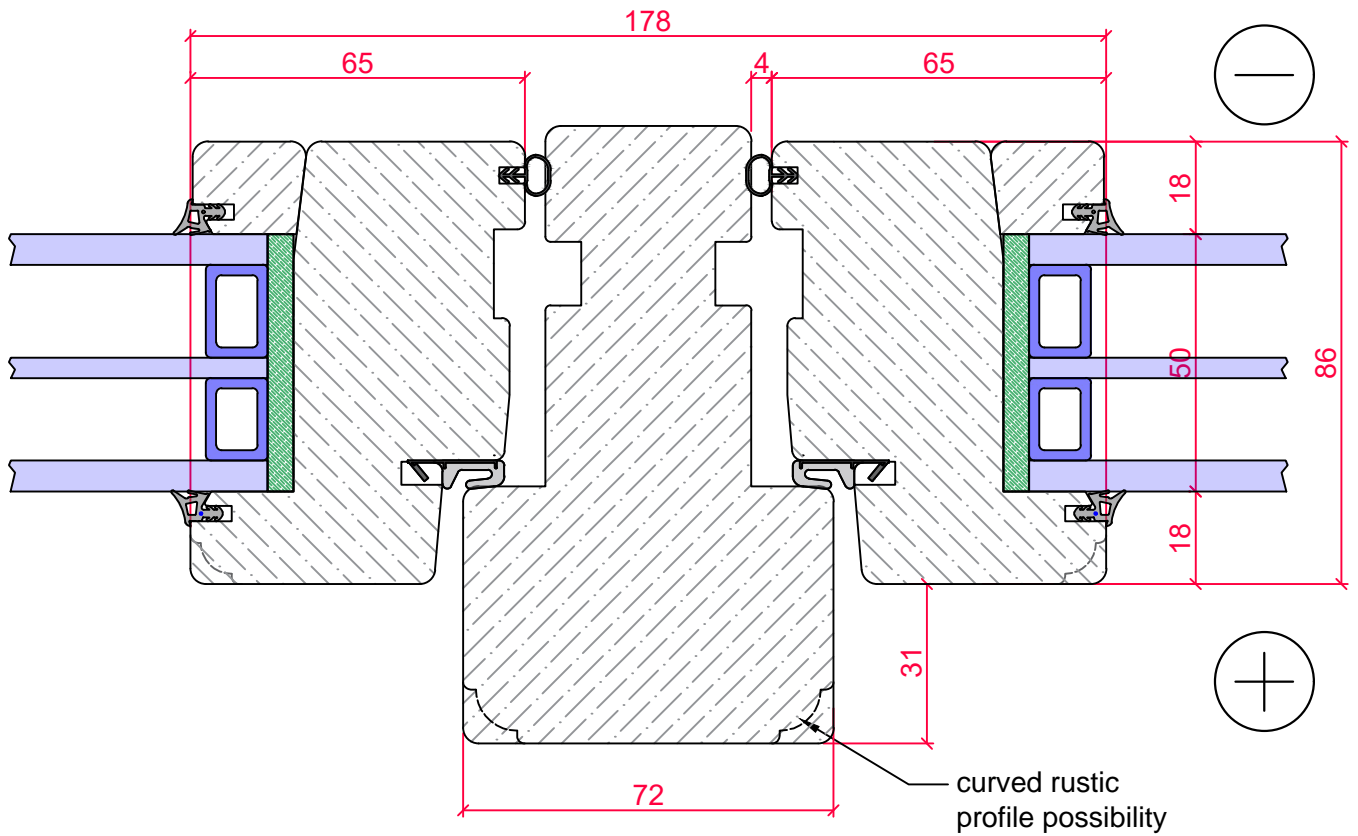

Vertical post cut between two operable sashes - M7

FAIL U:\Konstueerimine\Konstueerimise projektid 2021\TAANI AKEN			
DFRAFT:	VELJO LAANEMÄE	DATE:	29.09.2023
KOOSKÖLASTAS:		PROFILE No:	
APPROVED:			
SCALE: 1:1		DRAWING NR / SHEET Pos3	FORMAT: ISO expand A4 (210.00 x 297.00 MM)

REKMAN
TINGIMA TEEVUD AJAKAD JA VÕRUD

Rekman OÜ
 Reg. Nr. 10093586
 Paneeli 4, 11415 Tallinn
 TEL: 372 601 45 51
 FAX: 372 601 45 59
 E-mail: rekman@rekman.com
 www.rekman.ee

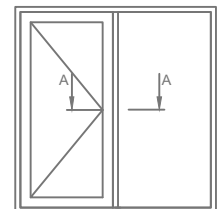
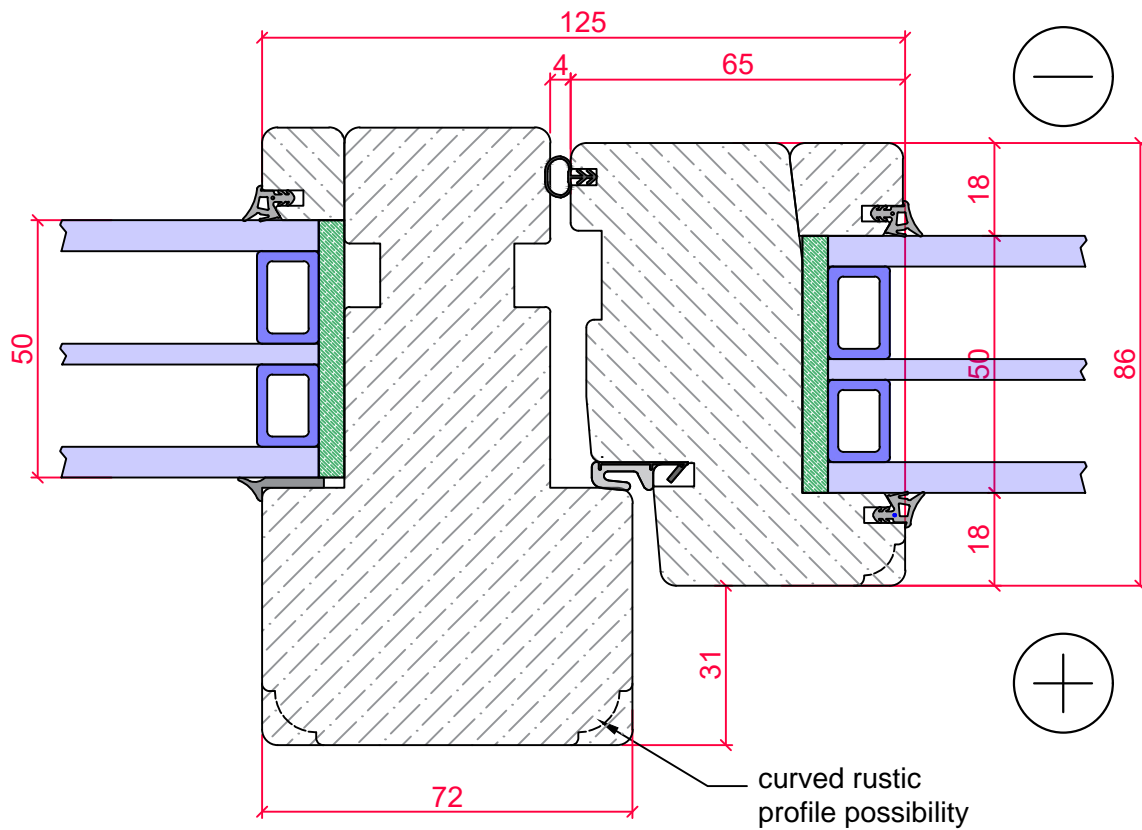

Openable and fixed window vertical post cut - M7

FAIL U:\Konstreeerimine\Konstreeerimise projektid 2021\TAANI AKEN

DFRAFT:	VELJO LAANEMÄE	DATE:	29.09.2023
KOOSKÖLASTAS:		PROFILE No:	
APPROVED:			
SCALE: 1:1		DRAWING NR / SHEET Pos4	FORMAT: ISO expand A4 (210.00 x 297.00 MM)

REKMAN

Rekman OÜ
 Reg. Nr. 10093586
 Paneeli 4, 11415 Tallinn
 TEL: 372 601 45 51
 FAX: 372 601 45 59
 E-mail: rekman@rekman.com
 www.rekman.ee

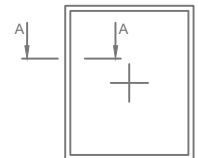
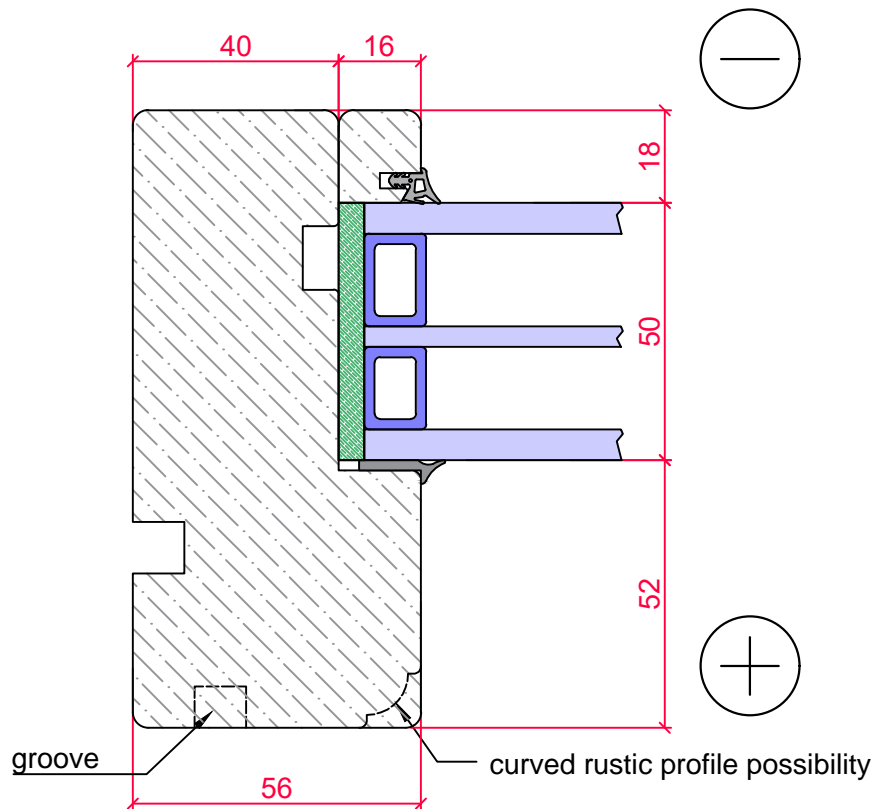

Fixed window side frame cut M7

FAIL U:\Konstrueerimine\Konstrueerimise projektid 2021\TAANI AKEN

DFRAFT:	VELJO LAANEMÄE	DATE:	29.09.2023
KOOSKÖLASTAS:		PROFILE No:	
APPROVED:			
SCALE: 1:1		DRAWING NR / SHEET Pos5	FORMAT: ISO expand A4 (210.00 x 297.00 MM)

REKMAN

Rekman OÜ
 Reg. Nr. 10093586
 Paneeli 4, 11415 Tallinn
 TEL: 372 601 45 51
 FAX: 372 601 45 59
 E-mail: rekman@rekman.com
 www.rekman.ee

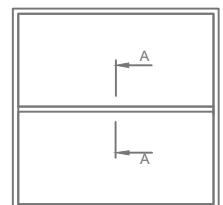
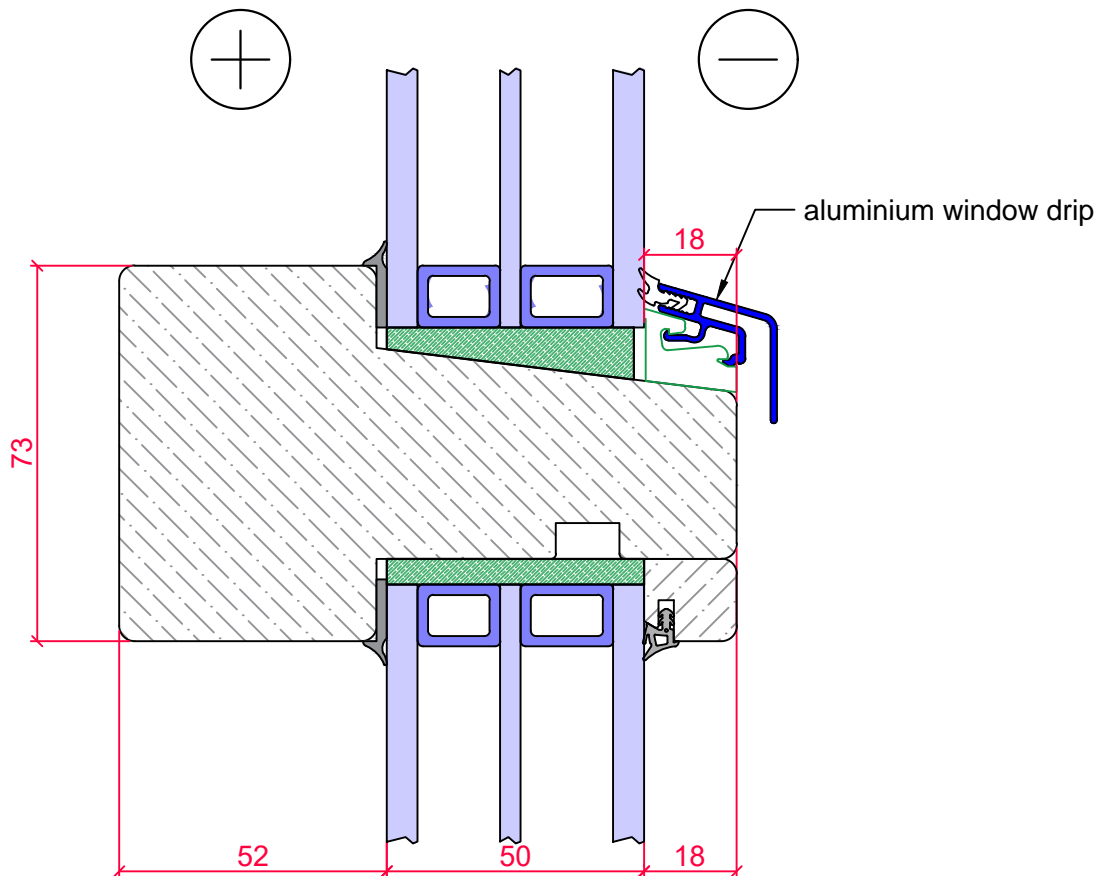

Fixed window dividing horizontal
post cut - M7

FAIL U:\Konstrueerimine\Konstrueerimise projektid 2021\TAANI AKEN

DFRAFT:	VELJO LAANEMÄE	DATE:	29.09.2023
KOOSKÖLASTAS:		PROFILE No:	
APPROVED:			
SCALE: 1:1		DRAWING NR / SHEET Pos6	FORMAT: ISO expand A4 (210.00 x 297.00 MM)

REKMAN

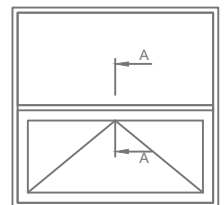
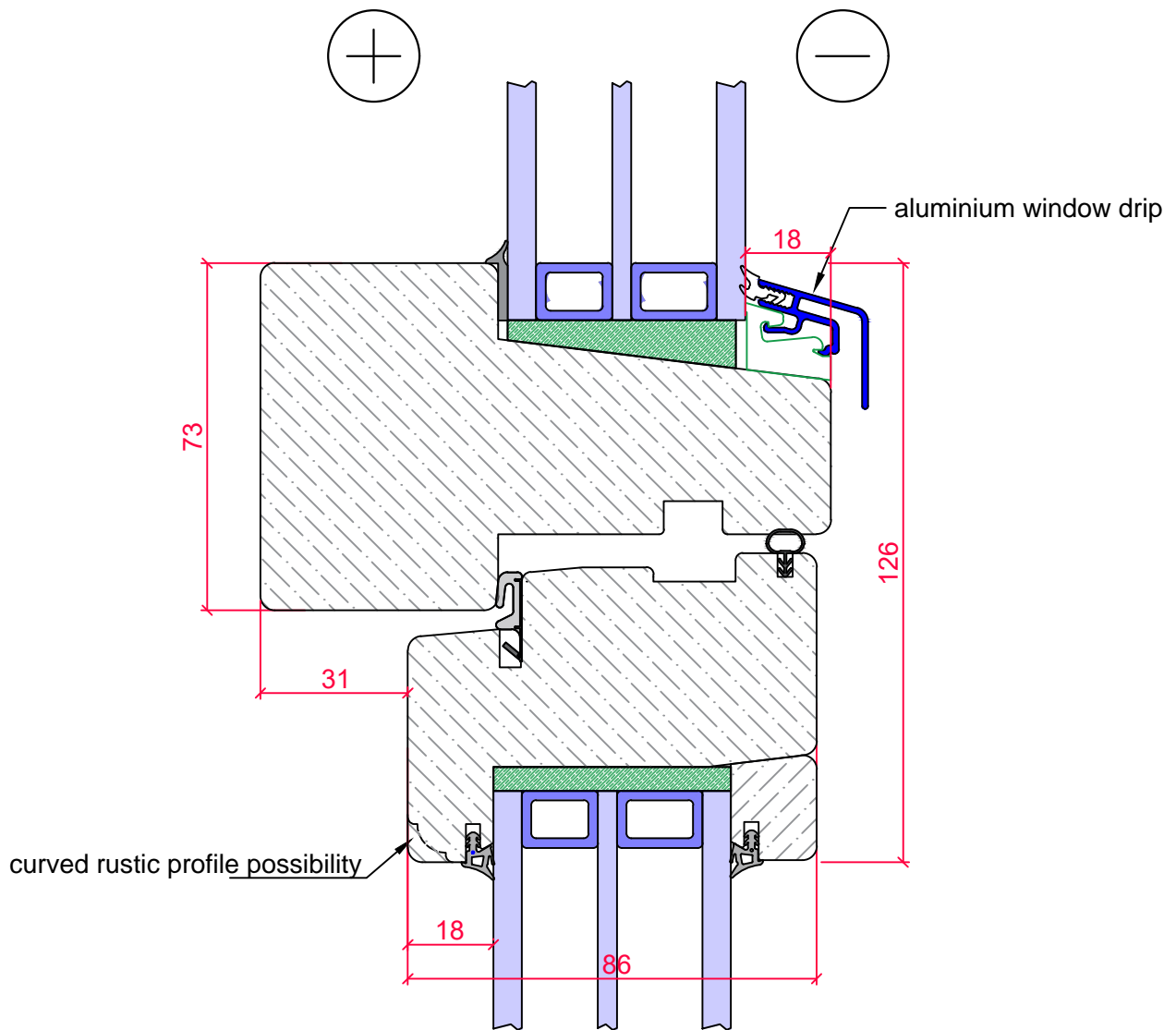

Rekman OÜ
 Reg. Nr. 10093586
 Paneeli 4, 11415 Tallinn
 TEL: 372 601 45 51
 FAX: 372 601 45 59
 E-mail: rekman@rekman.com
 www.rekman.ee



Openable-fixed window horizontal post cut - M7			
FAIL U:\Konstrueerimine\Konstrueerimise projektid 2021\TAANI AKEN			
DFRAFT:	VELJO LAANEMÄE	DATE:	29.09.2023
KOOSKÖLASTAS:		PROFILE No:	
APPROVED:			
SCALE: 1:1		DRAWING NR / SHEET Pos7	FORMAT: ISO expand A4 (210.00 x 297.00 MM)

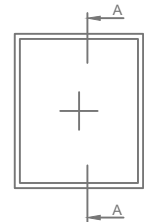
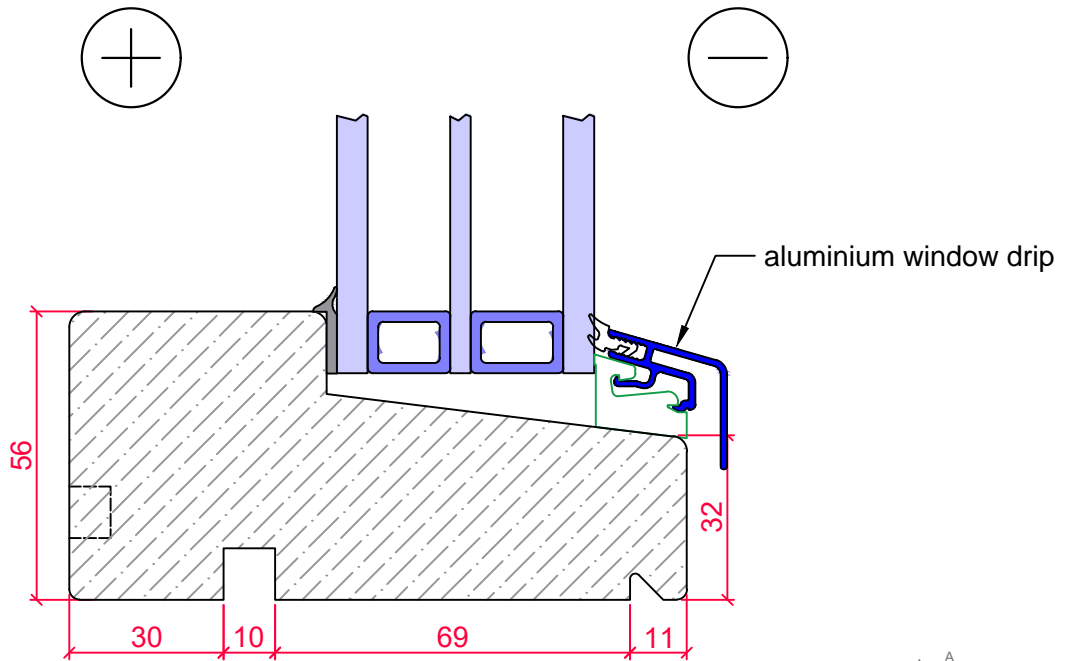
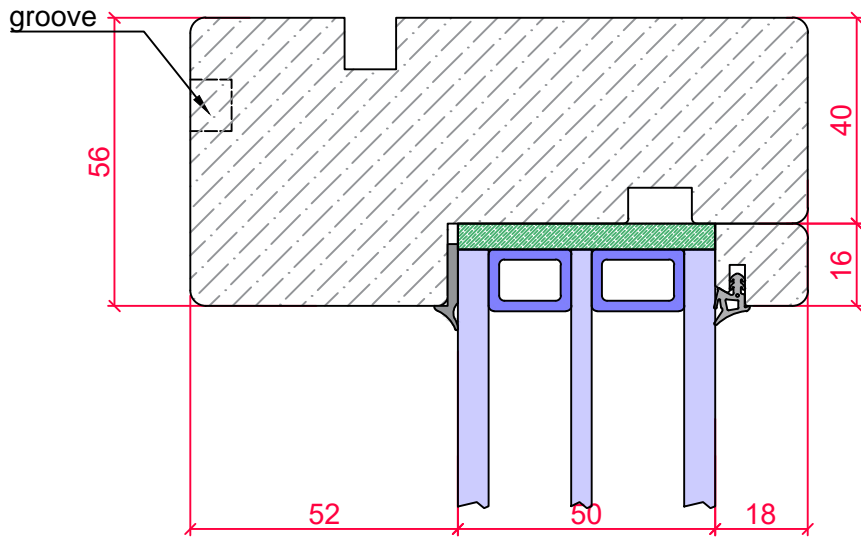

Rekman OÜ
 Reg. Nr. 10093586
 Paneeli 4, 11415 Tallinn
 TEL: 372 601 45 51
 FAX: 372 601 45 59
 E-mail: rekman@rekman.com
 www.rekman.ee



Fixed-fixed window upper and lower frame cut - M7

FAIL U:\Konstrueerimine\Konstrueerimise projektid 2021\TAANI AKEN

DFRAFT:	VELJO LAANEMÄE	DATE:	29.09.2023
KOOSKÖLASTAS:		PROFILE No:	
APPROVED:			
SCALE: 1:1		DRAWING NR / SHEET Pos8	FORMAT: ISO expand A4 (210.00 x 297.00 MM)

REKMAN

Rekman OÜ
 Reg. Nr. 10093586
 Paneeli 4, 11415 Tallinn
 TEL: 372 601 45 51
 FAX: 372 601 45 59
 E-mail: rekman@rekman.com
 www.rekman.ee

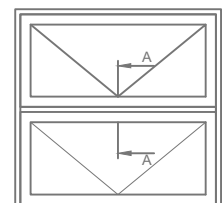
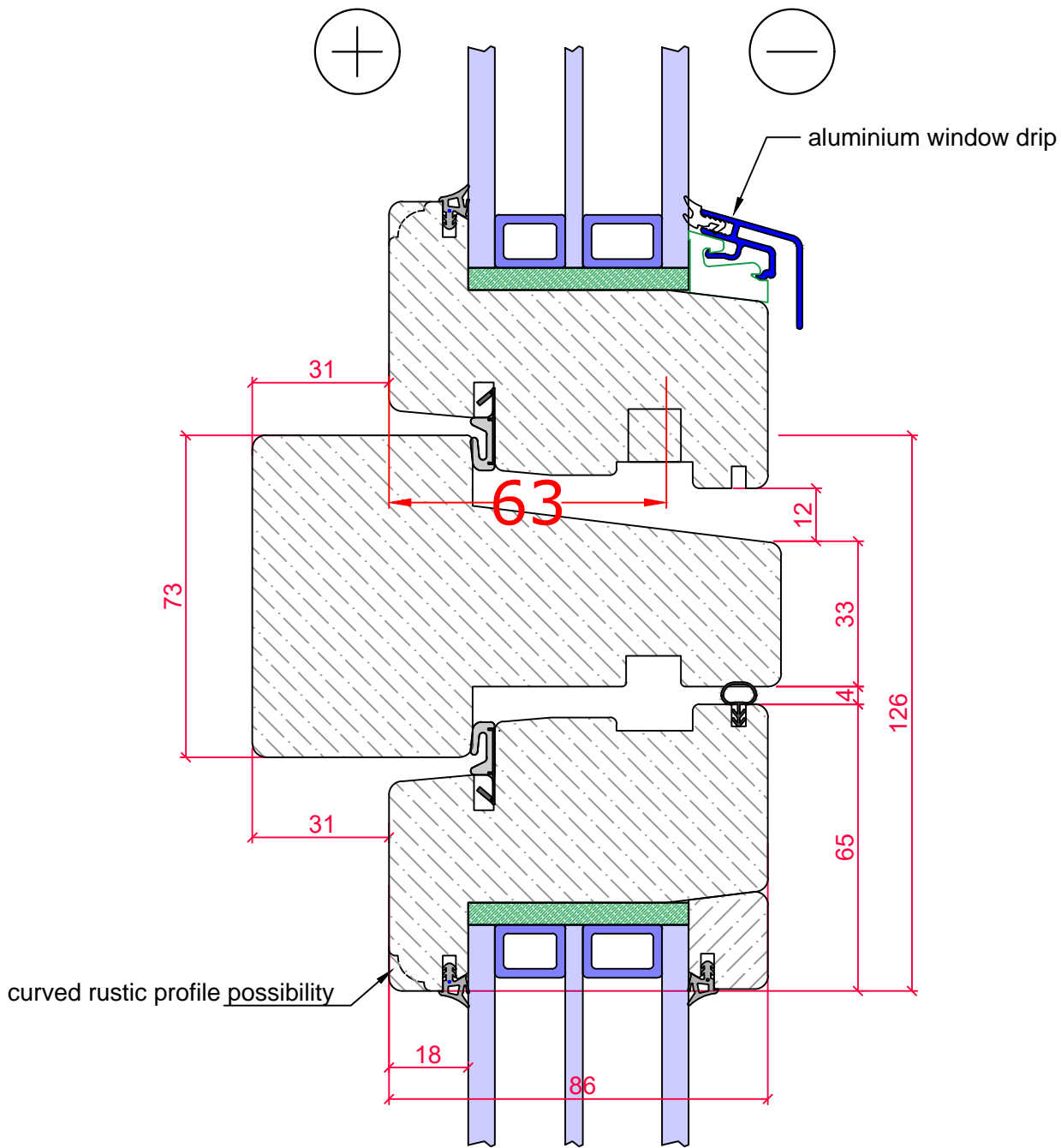

Openable-openable window dividing horizontal post cut - M7

FAIL U:\Konstrueerimine\Konstrueerimise projektid 2021\TAANI AKEN

DFRAFT:	VELJO LAANEMÄE	DATE:	29.09.2023
KOOSKÖLASTAS:		PROFILE No:	
APPROVED:			
SCALE: 1:1		DRAWING NR / SHEET Pos9	FORMAT: ISO expand A4 (210.00 x 297.00 MM)

REKMAN

Rekman OÜ
 Reg. Nr. 10093586
 Paneeli 4, 11415 Tallinn
 TEL: 372 601 45 51
 FAX: 372 601 45 59
 E-mail: rekman@rekman.com
 www.rekman.ee

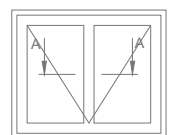
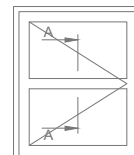
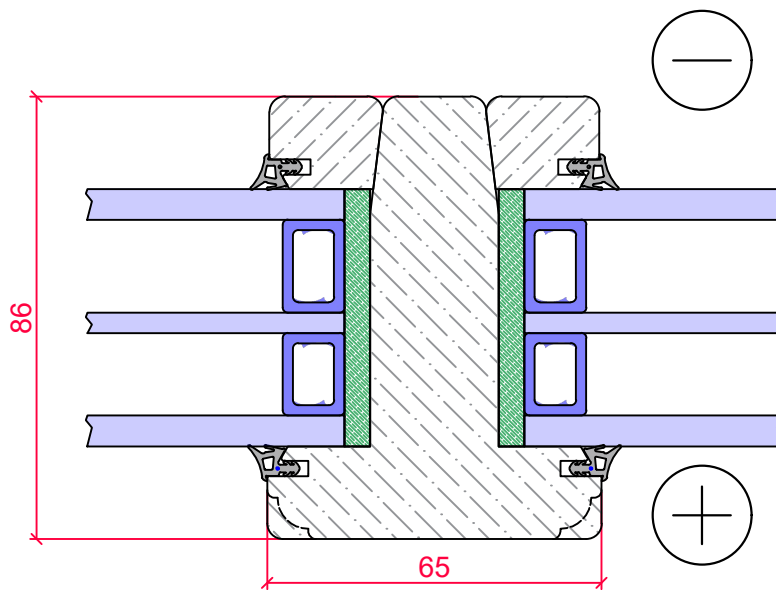
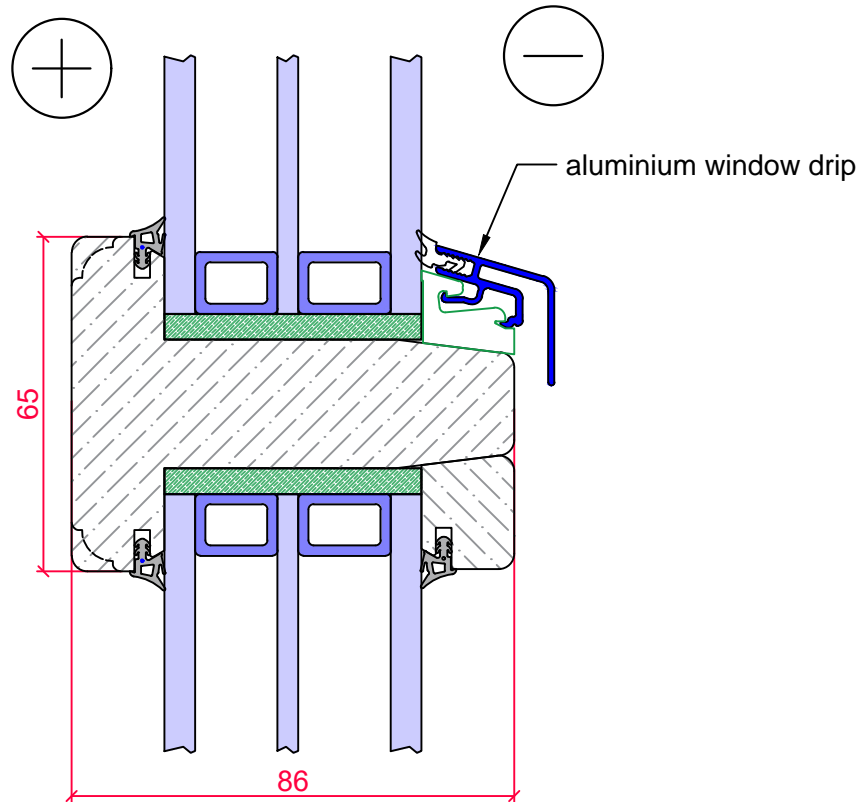

Openable sash muntins cut - M7

FAIL U:\Konstrueerimine\Konstrueerimise projektid 2021\TAANI AKEN

DFRAFT:	VELJO LAANEMÄE	DATE:	29.09.2023
KOOSKÖLASTAS:		PROFILE No:	
APPROVED:			
SCALE: 1:1		DRAWING NR / SHEET Pos10	FORMAT: ISO expand A4 (210.00 x 297.00 MM)

REKMAN

Rekman OÜ
 Reg. Nr. 10093586
 Paneeli 4, 11415 Tallinn
 TEL: 372 601 45 51
 FAX: 372 601 45 59
 E-mail: rekman@rekman.com
 www.rekman.ee